

JDB600 固体镶嵌自润滑轴承 JDB600 Cylindrical Oilless Bushing

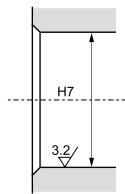
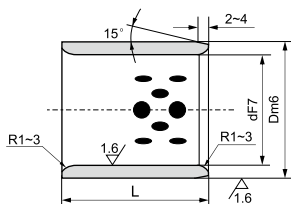
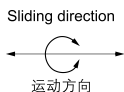

Mating Housing
相配座孔

内径 F7 I.D. Ø d		外径 m6 O.D. Ø D		长度 L ^{-0.1} _{-0.3}							
				8	10	12	15	16	19	20	25
6	+0.022 +0.010	10	+0.015 +0.006	061008	061010	061012					
8	+0.028 +0.013	12		081208	081210	081212	081215				
10		14	+0.018 +0.007	101408	101410	101412	101415			101420	
12		18		121808	121810	121812	121815	121816	121819	121820	121825
13		19			131910	131912	131915			131920	131925
14		20			142010	142012	142015			142020	142025
15	+0.034 +0.016	21			152110	152112	152115	152116		152120	152125
16		22			162210	162212	162215	162216	162219	162220	162225
17		23	+0.021 +0.008				172315				
18		24			182410	182412	182415	182416		182420	182425
19		26					192615			192620	
20		28			202810	202812	202815	202816	202819	202820	202825
20		30			203010	203012	203015	203016		203020	203025
22		32				223212	223215			223220	223225
25	+0.041 +0.020	33				253312	253315	253316		253320	253325
25		35				253512	253515	253516		253520	253525
28		38								283820	283825
30		40	+0.025 +0.009			303812	303815			303820	303825
30		40				304012	304015			304020	304025
32		42								324220	
35		44								354420	354425
35		45								354520	354525
38		48									
40		50					405015			405020	405025
40		50					405515				
45		55	+0.030 +0.011								
45		56									
45		60									

JDB600 固体镶嵌自润滑轴承

JDB600 Cylindrical Oilless Bushing



Material	600 # + Graphite
材质	高力黄铜 + 石墨

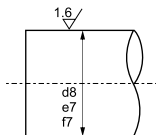

d8: High load 高负荷
 e7: Light load 轻负荷
 f7: High precision 高精度

Mating Shaft
相配轴

单位unit:mm

长度 $L_{-0.1}^{+0.1}$							压装后内孔	适用垫圈	内径
30	35	40	50	60	70	80	I.D. After Press-Fitting	JTW	I.D. $\varnothing d$
							+0.019 +0.007	—	6
							+0.025 +0.010	—	8
							+0.031 +0.013	10	10
121830							+0.030 +0.012	12	12
131930						13		13	
142030						14		14	
152130	152135	152140				15		15	
162230	162235	162240				16		16	
						18		17	
182430	182435	182440				18		18	
						20		19	
202830	202835	202840	202850			20		20	
203030	203035	203040	203050			20		20	
						25	22		
253330	253335	253340	253350	253360			+0.037 +0.016	25	25
253530	253535	253540	253550	253560				25	25
283830		283840						30	28
303830	303835	303840	303850	303860				30	30
304030	304035	304040	304050	304060				30	30
324230		324240						35	32
354430	354435	354440	354450	354460				35	35
354530	354535	354540	354550	354560				35	35
		384840						40	38
405030	405035	405040	405050	405060	405070	405080		40	40
405530	405535	405540	405550	405560			+0.045 +0.020	40	40
455530	455535	455540	455550	455560				45	45
455630	455635	455640	455650	455660				45	45
456030	456035	456040	456050	456060	456070	456080		45	45

自润滑和免维护滑动轴承

JDB600 固体镶嵌自润滑轴承 JDB600 Cylindrical Oilless Bushing

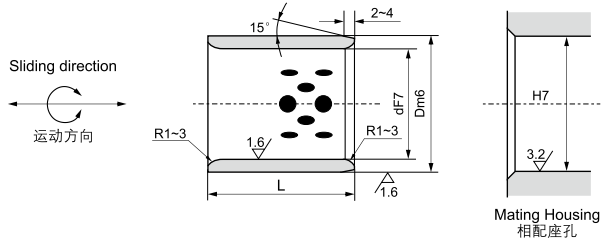

内径 F7 I.D. Ø d		外径 m6 O.D. Ø D		长度 L _{0.1} ^{0.1}							
				20	30	35	40	50	60	70	80
50	+0.050 +0.025	60	+0.030 +0.011	506020	506030	506035	506040	506050	506060	506070	506080
50		62		506230	506235	506240	506250	506260	506270	506280	
50		65		506530	506540	506550	506560	506570	506580		
55	+0.060 +0.030	70	+0.035 +0.013	557030	557035	557040	557050	557060	557070		
60		74		607430	607435	607440	607450	607460	607470	607480	
60		75		607530	607535	607540	607550	607560	607570	607580	
63		75						637560	637570	637580	
65		80				658040	658050	658060	658070	658080	
70	+0.071 +0.036	85	+0.040 +0.015	708530	708535	708540	708550	708560	708570	708580	
70		90				709050	709060	709070	709080		
75		90				759050	759060	759070	759080		
75		95				759550	759560	759570	759580		
80		96				809640	809650	809660	809670	809680	
80	+0.083 +0.043	100	+0.046 +0.017			8010040		8010060	8010070	8010080	
85		100					8510060		8510080		
90		110				9011050	9011060		9011080		
100		120				10012050	10012060	10012070	10012080		
110		130				11013050		11013070	11013080		
120	+0.096 +0.050	140	+0.046 +0.017					12014070	12014080		
125		145									
130		150							13015080		
140		160									
150		170							15017080		
160	+0.096 +0.050	180	+0.046 +0.017						16018080		
170		190									
180		200									
190		210									
200	230										

JDB600 固体镶嵌自润滑轴承
JDB600 Cylindrical Oilless Bushing



Material	600 # + Graphite
材质	高力黄铜 + 石墨

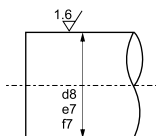

d8: High load 高负荷
 e7: Light load 轻负荷
 f7: High precision 高精度

Mating Shaft
 相配轴

单位unit:mm

长度 L _{-0.1} ^{0.3}							压装后内孔 I.D. After Press- Fitting	适用垫圈 JTW	内径 I.D. Ø d	
90	100	120	130	140	150	200				
							+0.045 +0.020	50	50	
	5065100								50	
							+0.055 +0.025	55	55	
	6075100								60	
									60	
	7085100								63	
									65	
	7590100						+0.054 +0.024	70	70	
	7595100								70	
	8096100	8096120							75	
	80100100	80100120		80100140			80	80	80	
									80	
9011090	90110100	90110120					+0.065 +0.030	90	85	
									90	
10012090	100120100	100120120		100120140			+0.064 +0.029	100	100	
	110130100	110130120							100	
12014090	120140100	120140120		120140140			+0.076 +0.036	120	110	
	125145100	125145120							120	
	130150100		130150130				+0.076 +0.036	—	125	
	140160100			140160140					130	
	150170100				150170150				140	
	160180100				160180150				150	
	170190100				170190150				160	
	180200100				180200150				170	
	190210100				190210150				180	
					200230150	200230200			+0.088	190
									+0.042	200

自润滑和免维护滑动轴承

JFB600 自润滑翻边轴套 JFB600 Metric Flanged Bushes

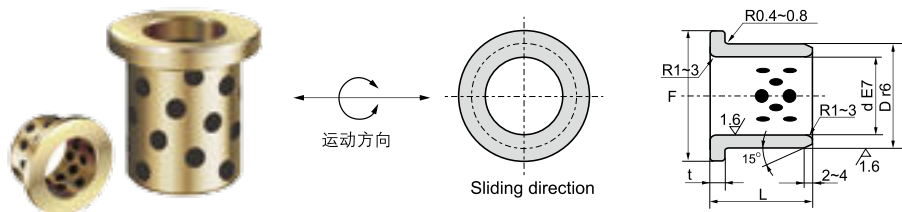

内径 E7 I.D. Ø d	外径 r6 O.D. Ø D	翻边 Flange		长度 L ^{-0.1} _{-0.3}											
		Ø F	t	10	12	15	17	18	20	23	25				
6	+0.032 +0.020	10	+0.028 +0.019	16	2	0610	0612								
8	+0.040 +0.025	12		20		0810	0812	0815							
10		14	+0.034 +0.023	22	3	1010	1012	1015	1017		1020				
12		18		25		1210	1212	1215			1220			1225	
13		19		26	3	1310	1312	1315		1320			1325		
14	+0.050 +0.032	20		27					1415		1420			1425	
15		21	+0.041 +0.028	28	3	1510	1512	1515		1520			1525		
16		22		29				1612	1615		1618	1620	1623	1625	
18		24		32	3			1815		1820			1825		
20		30		40					2015		2020			2025	
25	+0.061 +0.040	35		45	3			2515		2520			2525		
30		40		50							3020			3025	
31.5		40	+0.050 +0.034	50	5					3120					
35		45		60							3520			3525	
40	+0.075 +0.050	50		65	0					4020			4025		
45		55		70		-0.1									
50		60	+0.060 +0.041	75	0										
55		65		80											
60		75		90	7.5										
63		75	+0.062 +0.043	85											
65	+0.090 +0.060	80		95	7.5										
70		85		105											
75		90	+0.073 +0.051	110	7.5										
80		100		120											
90		110	+0.076 +0.054	130	7.5										
100	+0.107 +0.072	120		150											
120		140	+0.088 +0.063	170	10										
130		150	+0.090 +0.065	180											
140	+0.125 +0.085	160		190	10										
150		170	+0.093 +0.068	200											
160		180		210											

JFB600 自润滑翻边轴套
JFB600 Metric Flanged Bushes



Material	600 # + Graphite
材质	高力黄铜 + 石墨

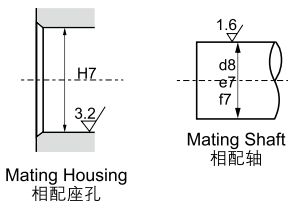

d8: High load 高负荷
 e7: Light load 轻负荷
 f7: High precision 高精度

单位unit:mm

长度 L ^{-0.1} / _{-0.3}									压装后内孔 I.D. After Press-Fitting	内径 I.D. Ø d
30	35	40	50	60	67.5	80	100	120	+0.016 +0.004	6
									+0.021 +0.006	8
									+0.031 +0.013	10
1230										12
1330										13
										14
1530									+0.026 +0.008	15
1630	1635	1640								16
1830	1835	1840								18
2030	2035	2040							+0.037 +0.016	20
2530	2535	2540	2550						+0.032 +0.011	25
3030	3035	3040	3050							30
3130	3135	3140								31.5
3530	3535	3540	3550						+0.046 +0.021	35
4030	4035	4040	4050							40
4530	4535	4540	4550	4560					+0.040 +0.015	45
5030	5035	5040	5050	5060					+0.055 +0.025	50
		5540		5560						55
		6040	6050	6060		6080			+0.053 +0.023	60
					6367					63
				6560						65
			7050			7080				70
				7560					+0.046 +0.016	75
				8060		8080	80100			80
				9060		9080			+0.060 +0.025	90
						10080	100100			100
						12080	120100		+0.052 +0.017	120
						13080	130100		+0.068 +0.028	130
						14080	140100			140
							150100	150120	+0.065 +0.025	150
							160100	160120		160

自润滑和免维护滑动轴承

JDBB 自润滑翻边轴套 JDBB Metric Flange Bushes

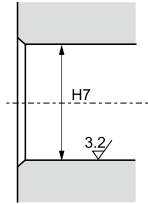
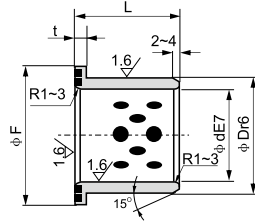
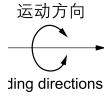

Mating Housing
相配座孔

内径 E7 I.D. ϕd		外径 r6 O.D. ϕD		翻边 Flange		长度 L ^{-0.1} _{0.3}														
				ϕF	t	10	11	12	13	15	18	20	23	25						
6	+0.032 +0.020	10	+0.028 +0.019	20	3	0610	0611	0612												
8	+0.040 +0.025	12	+0.034 +0.023	25				0812	0813	0815										
10		14		25					1013	1018										
12	+0.050 +0.032	18	+0.041 +0.028	30			1211				1218	1223								
13		19		30					1313	1318	1323									
15		21		35						1513	1518	1523								
16		22		35		0					1613	1618	1623	1625						
18	+0.061 +0.040	24	+0.050 +0.034	40		-0.03					1818	1823								
20		28		45										2020	2025					
25		33		50											2520	2525				
30		38		55											3020	3025				
35		44		65												3520	3525			
40	+0.075 +0.050	50	+0.060 +0.041	70	7															
50	62	90		8																
60	+0.090 +0.060	74		+0.062 +0.043	110															
70		85		+0.073 +0.051	120	10														
80		96		140																

JDBB 自润滑翻边轴套
JDBB Metric Flange Bushes



Material	600 # + Graphite
材质	高力黄铜 + 石墨

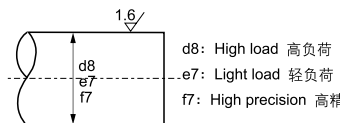

Mating Shaft
 相配轴

单位unit:mm

长度 L $\begin{smallmatrix} +0.1 \\ -0.3 \end{smallmatrix}$											压装后内孔 I.D. After Press-Fitting	内径 d	
27	35	37	38	47	48	50	58	60	68	80	90	+0.016 +0.004	6
												+0.021 +0.006	8
												+0.031 +0.013	10
													12
													13
												+0.026 +0.008	15
													16
													18
												+0.037 +0.016	20
												+0.032 +0.011	25
	3035												30
	3535											+0.046 +0.021	35
4027		4037		4047									40
			5038		5048		5058					+0.040 +0.015	50
			6038		6048		6058		6068			+0.053 +0.023	60
						7050				7080			70
							8060				8090	+0.046 +0.016	80

自润滑和免维护滑动轴承

JFFB 自润滑轴瓦 JFFB Half-Bearing

Material	600 # + Graphite
材质	高力黄铜 + 石墨

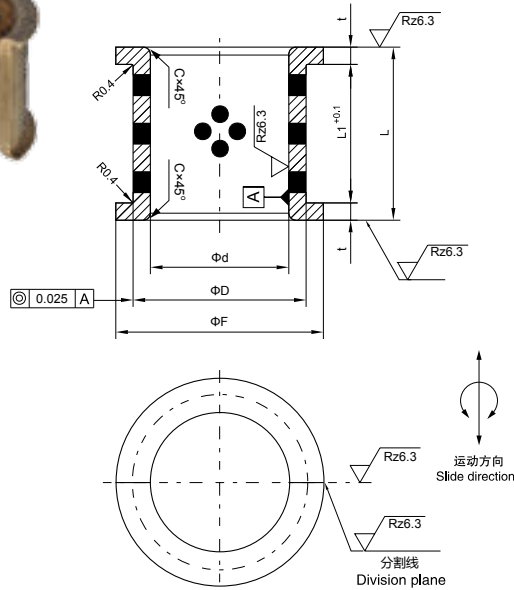

单位unit:mm

产品代号 Standard No.	内径 H7 I.D. Φd	外径 O.D. ΦD	ΦF d_{11}	L h_{12}	$L_{1+0.1}$ 0	t	C	
JFFB-030	30	38	s6	48	34	22	6	1
JFFB-035	35	45		55	45	32	6.5	
JFFB-040	40	50		60	50	35	7.5	
JFFB-045	45	55		65	55	40	7.5	
JFFB-050	50	60		70	60	45	7.5	
JFFB-060	60	70		80	70	50	10	
JFFB-070	70	85		95	80	60	10	
JFFB-080	80	95	r6	110	95	70	12.5	2
JFFB-090	90	105		120	105	80	12.5	
JFFB-100	100	115		130	115	90	12.5	
JFFB-110	110	125		140	125	100	12.5	
JFFB-120	120	135		150	140	110	15	
JFFB-140	140	160		175	160	120	20	
JFFB-160	160	180		200	180	140	20	

JTW600 标准止推垫片
JTW600 Oilless Thrust Washer



Material	600 # + Graphite
材质	高力黄铜 + 石墨

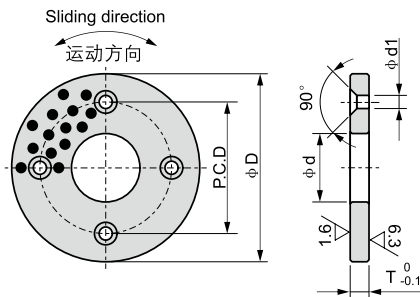

单位unit:mm

型号规格 Standard No.	I.D. 内径 ϕd	O.D. 外径 ϕD	厚度 Thickness	螺丝孔 Screw Holes				
				P.C.D	数量 Number of Holes	规格 Flat Head Screw	d1	
JTW-0603	6.2	25	3	15	2	M3	3.5	
JTW-0803	8.2	28		18				
JTW-1003	10.2	30		20				
JTW-1203	12.2	30		28				
JTW-1203N	12.2	40		Without flat head screw hole 无定位孔				
JTW-1303	13.2	50		28	2	M3	3.5	
JTW-1403	14.2			35				
JTW-1503	15.2			35				
JTW-1603	16.2	50		Without flat head screw hole 无定位孔				
JTW-1603N	16.2			35	M3	3.5		
JTW-1803	18.2	55	5	35	2	M5	6	
JTW-2005	20.2							40
JTW-2505	25.2							45
JTW-3005	30.2							50
JTW-3505	35.2	70	7	60	M6	7		
JTW-4007	40.2			70				
JTW-4507	45.2			75				
JTW-5008	50.3	110	8	85	M8	9		
JTW-5508	55.3			90				
JTW-6008	60.3			95				
JTW-6508	65.3			100				
JTW-7010	70.3	140	10	110	M10	11		
JTW-7510	75.3			120				
JTW-8010	80.3			140				
JTW-9010	90.5			160				
JTW-10010	100.5	200	10	175				
JTW-12010	120.5							

自润滑和免维护滑动轴承

JDBS 自润滑关节轴承 JDBS Metric Spherical Bushes

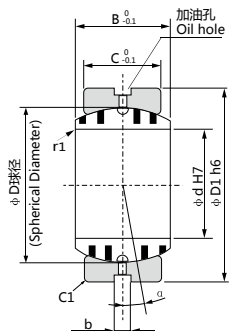

Spherical bushing assembly

关节轴承的装配
JDBS 015~090

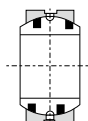

JDBS ≥ 100

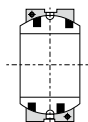

Fixing direction

安装方向

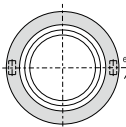
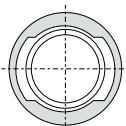

Inner ring 内圈	Material 材质	600 # + Gr/石墨
Outer ring 外圈	Material 材质	S45C
	Hardness 硬度	HRC 25~30

座孔 Housing: H7
轴 Shaft: g6



单位unit:mm

型号规格 Standard No.	d	H7	D1	h6	B	C	D	b	调整角度 Alignment Angle α°	径向承载 Allowable Radial Load (kN)	轴向承载 Allowable Thrust Load (kN)
JDBS-015	15	$^{+0.018}_0$	26	$^0_{-0.013}$	12	9	22		8	6.5	0.5
JDBS-020	20		32		16	14	28		4	12.6	1.4
JDBS-025	25	$^{+0.021}_0$	42	$^0_{-0.016}$	21	18	36		5	21.8	2.5
JDBS-030	30		50		27	23	44		6	32.0	3.5
JDBS-035	35		55		30	26	49		5	43.7	4.8
JDBS-040	40	$^{+0.025}_0$	62	$^0_{-0.019}$	33	28	55	4	6	54.7	5.7
JDBS-045	45		72		36	31	62		5	69.7	7.2
JDBS-050	50		80		42	36	70		5	92.4	10
JDBS-060	60	$^{+0.030}_0$	100	$^0_{-0.022}$	53	45	90		6	143	16
JDBS-070	70		110		58	50	99		5	181	20
JDBS-080	80		130		70	60	115		6	254	30
JDBS-090	90		140		76	65	125		6	313	36
JDBS-100	100	$^{+0.035}_0$	160	$^0_{-0.025}$	88	75	145		6	544	64
JDBS-110	110		170		93	80	155		5	642	73
JDBS-120	120		190		105	90	17		6	797	94
JDBS-130	130		200		110	95	180		5	880	105
JDBS-140	140	$^{+0.040}_0$	210	$^0_{-0.029}$	90	70	180	6	7	668	56
JDBS-150	150		220		120	105	200		5	1135	129
JDBS-160	160		230		105	80	200		8	891	73
JDBS-180	180	$^{+0.046}_0$	260	$^0_{-0.032}$	105	80	225		6	1002	74
JDBS-200	200		290		130	100	250		7	1434	117
JDBS-220	220		320		135	100	275		8	1577	118
JDBS-240	240	$^{+0.052}_0$	340	$^0_{-0.036}$	140	100	300		8	1720	118
JDBS-260	260		370		150	110	325	9	7	2072	143
JDBS-280	280		400		155	120	350		6	2455	172
JDBS-300	300		430	$^0_{-0.040}$	165	120	375		7	2630	

JESW 自润滑板
JESW Oilless Wear Plate



Material	600 # + Graphite
材质	高力黄铜 + 石墨

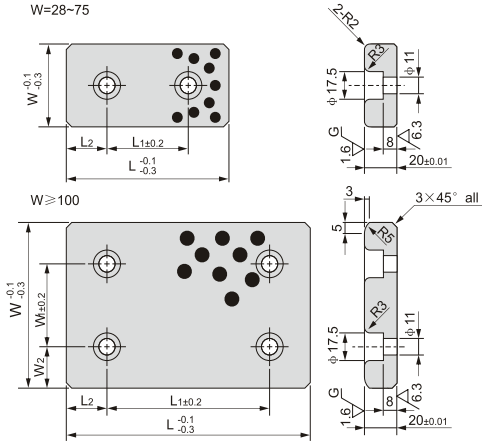

单位unit:mm

型号规格 Standard No.	W	L	W ₁	W ₂	L ₁	L ₂
JESW-28 × 75	28	75			45	15
JESW-28 × 100		100			50	25
JESW-28 × 150		150			100	
JESW-38 × 75	38	75			45	15
JESW-38 × 100		100			50	25
JESW-38 × 150		150			100	
JESW-48 × 75	48	75			45	15
JESW-48 × 100		100			50	
JESW-48 × 125		125			75	25
JESW-48 × 150		150	-	-	100	
JESW-48 × 200		200			150	
JESW-58 × 75		75			45	
JESW-58 × 100	58	100			50	
JESW-58 × 150		150			100	
JESW-75 × 75		75			25	
JESW-75 × 100	75	100			50	25
JESW-75 × 125		125			75	
JESW-75 × 150		150			100	
JESW-75 × 200		200			150	

型号规格 Standard No.	W	L	W ₁	W ₂	L ₁	L ₂	
JESW-100 × 100	100	100			50		
JESW-100 × 125		125			75		
JESW-100 × 150		150			100		25
JESW-100 × 200	100	200	25		150		
JESW-100 × 250		250			200		
JESW-100 × 300		300			200		50
JESW-125 × 125	125	125	50		75		
JESW-125 × 150		150			100		
JESW-125 × 200		200			150		25
JESW-125 × 250	125	250	37.5		200		
JESW-125 × 300		300			200		50
JESW-125 × 350		350			200		75
JESW-150 × 150	150	150	100	25	100		
JESW-150 × 200		200			150		25
JESW-150 × 250		250			200		

自润滑和免维护滑动轴承

JTWP 自润滑板 JTWP Oilless Wear Plate

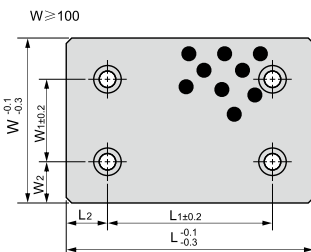
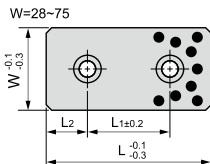
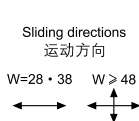

DSEW	500 # + Graphite 高力黄铜 + 石墨
DSEF	FC250 + Graphite 铸铁 + 石墨

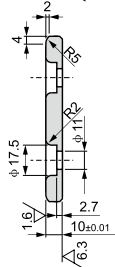
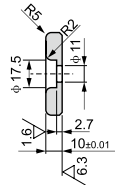

单位unit:mm

型号规格 Standard No.	W	L	W ₁	W ₂	L ₁	L ₂
JTWP-28 × 75	28	75			45	15
JTWP-28 × 100		100			50	
JTWP-28 × 125		125			75	25
JTWP-28 × 150		150			100	
JTWP-38 × 75	38	75			45	15
JTWP-38 × 100		100			50	
JTWP-38 × 125		125			75	25
JTWP-38 × 150		150			100	
JTWP-48 × 75	48	75			45	15
JTWP-48 × 100		100			50	
JTWP-48 × 125		125			75	25
JTWP-48 × 150		150			100	
JTWP-48 × 200		200			150	
JTWP-58 × 75		58			75	
JTWP-58 × 100	100		50	25		
JTWP-58 × 150	150		100			

型号规格 Standard No.	W	L	W ₁	W ₂	L ₁	L ₂		
JTWP-75 × 75	75	75			25			
JTWP-75 × 100		100			50			
JTWP-75 × 125		125			-	-	75	
JTWP-75 × 150		150					100	
JTWP-75 × 200	200			150				
JTWP-100 × 100	100	100			50			
JTWP-100 × 125		125			75			
JTWP-100 × 150		150			25	100	25	
JTWP-100 × 200		200				150		
JTWP-100 × 250	250		50		200			
JTWP-125 × 150	150	150			100			
JTWP-125 × 200		200			37.5	150		
JTWP-125 × 250		250				200		
JTWP-150 × 150		150			100	25	100	
JTWP-150 × 200	200			150				

JUWP 自润滑板
JUWP Oilless Wear Plate

Material	600 # + Graphite
材质	高力黄铜+石墨

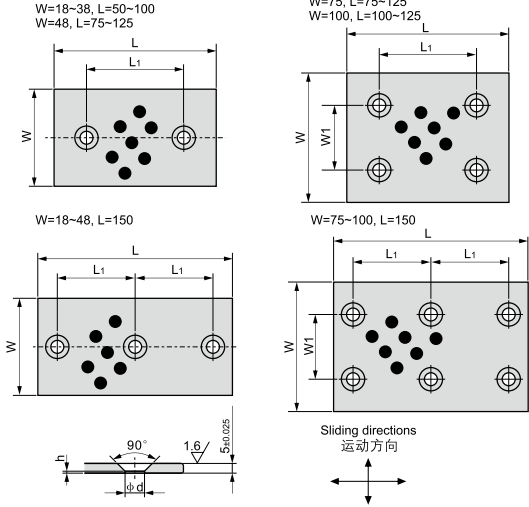

单位unit:mm

型号规格 Standard No.	W	L	W ₁	L ₁	d	h	螺栓 Mounting Bolt
JUWP 18 × 50	18	50	-	20	6.5	1.5	M6
JUWP 18 × 75		75		45			
JUWP 18 × 100		100		70			
JUWP 18 × 150		150		60			
JUWP 28 × 50	28	50	-	20	10	0.8	M8
JUWP 28 × 75		75		45			
JUWP 28 × 100		100		70			
JUWP 28 × 150		150		60			
JUWP 38 × 50	38	50	-	20	10	0.8	M8
JUWP 38 × 75		75		45			
JUWP 38 × 100		100		70			
JUWP 38 × 150		150		60			

型号规格 Standard No.	W	L	W ₁	L ₁	d	h	螺栓 Mounting Bolt
JUWP 48 × 75	48	75	-	45	10	0.8	M8
JUWP 48 × 100		100		70			
JUWP 48 × 125		125		95			
JUWP 48 × 150		150		60			
JUWP 75 × 75	75	75	45	45	10	0.8	M8
JUWP 75 × 100		100		70			
JUWP 75 × 125		125		95			
JUWP 75 × 150		150		60			
JUWP 100 × 100	100	100	70	70	10	0.8	M8
JUWP 100 × 125		125		95			
JUWP 100 × 150		150		60			

自润滑和免维护滑动轴承

JOLP 自润滑板 JOLP Oilless Wear Plate

Material	600 # + Graphite
材质	高力黄铜 + 石墨

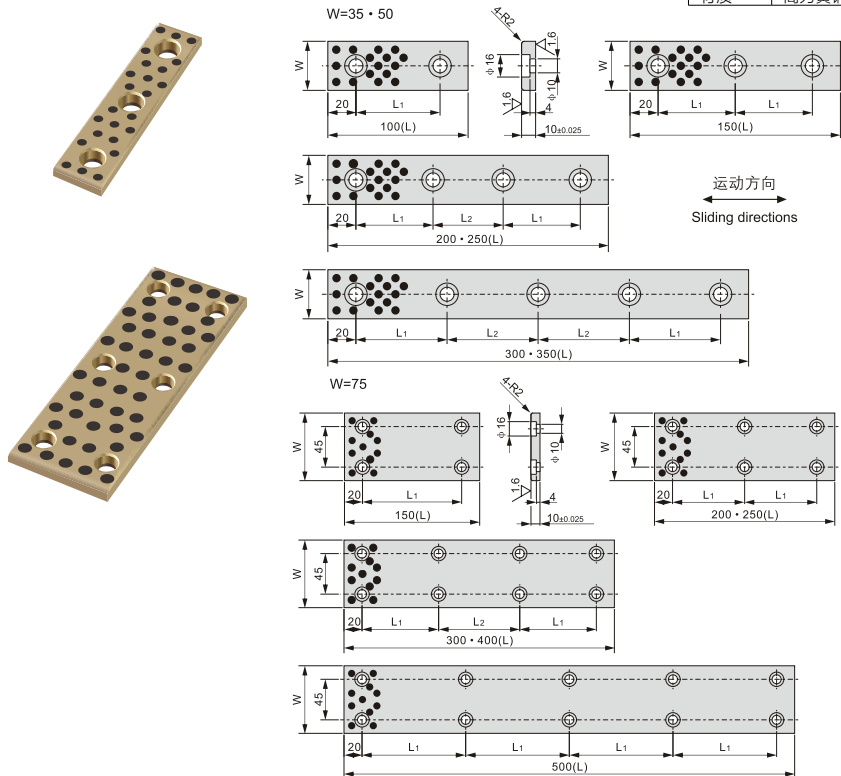

单位:unit:mm

型号规格 Standard No.	W	L	螺栓位置 Bolt Position		螺栓数量 Bolt Q'ty
			L ₁	L ₂	
JOLP-35 × 100	35	100	60	-	2
JOLP-35 × 150		150	55	-	3
JOLP-35 × 200		200	55	50	4
JOLP-35 × 250		250	70	70	5
JOLP-35 × 300		300	65	65	5
JOLP-50 × 100	50	100	60	-	2
JOLP-50 × 150		150	55	-	3
JOLP-50 × 200		200	55	50	4

型号规格 Standard No.	W	L	螺栓位置 Bolt Position		螺栓数量 Bolt Q'ty
			L ₁	L ₂	
JOLP-50 × 250	50	250	70	70	4
JOLP-50 × 300		300	65	65	5
JOLP-50 × 350		350	80	75	5
JOLP-75 × 150		150	110	-	4
JOLP-75 × 200	75	200	80	-	6
JOLP-75 × 250		250	105	-	6
JOLP-75 × 300		300	85	90	8
JOLP-75 × 400		400	120	120	8
JOLP-75 × 500		500	115	-	10

JOML 自润滑板
JOML Oilless Wear Plate



Material	600 # + Graphite
材质	高力黄铜 + 石墨

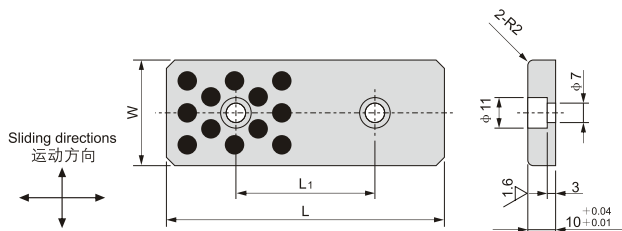

单位unit:mm

型号规格 Standard No.	W	L	L ₁
JOML-18x75	18	75	45
JOML-18x100		100	50
JOML-18x125		125	75
JOML-18x150		150	100
JOML-28x75	28	75	45
JOML-28x100		100	50
JOML-28x125		125	75
JOML-28x150		150	100
JOML-38x75	38	75	45
JOML-38x100		100	50
JOML-38x125		125	75
JOML-38x150		150	100
JOML-48x75	48	75	45
JOML-48x100		100	50
JOML-48x125		125	75
JOML-48x150		150	100

自润滑和免维护滑动轴承

JTLP 自润滑板 JTLP Oilless Wear Plate



Material	600 # + Graphite
材质	高力黄铜 + 石墨



W=18 · 28 · 38 · 48

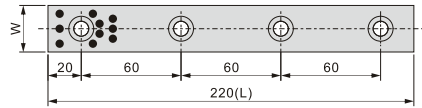
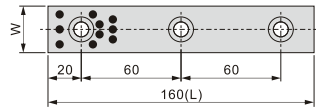
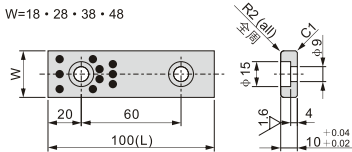

单位unit:mm

型号规格 Standard No.	W	L
JTLP-18x100	18	100
JTLP-18x160		160
JTLP-18x220		220
JTLP-28x100	28	100
JTLP-28x160		160
JTLP-28x220		220
JTLP-38x100	38	100
JTLP-38x160		160
JTLP-38x220		220
JTLP-48x100	48	100
JTLP-48x160		160
JTLP-48x220		220
JTLP-58x100	58	100
JTLP-58x160		160
JTLP-58x220		220
JTLP-68x100	68	100
JTLP-68x160		160
JTLP-68x220		220

W=58 · 68

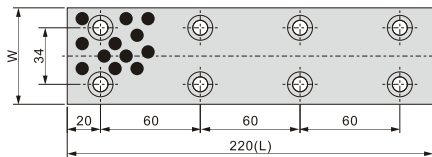
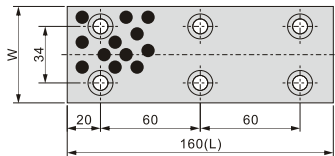
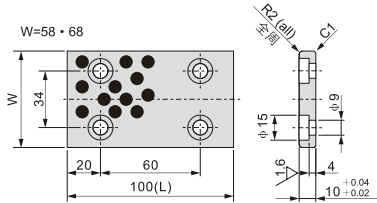

Sliding directions



JGLDW 自润导轨
JGLDW Oilless Guide Rail



Material	600 # + Graphite
材质	高力黄铜 + 石墨

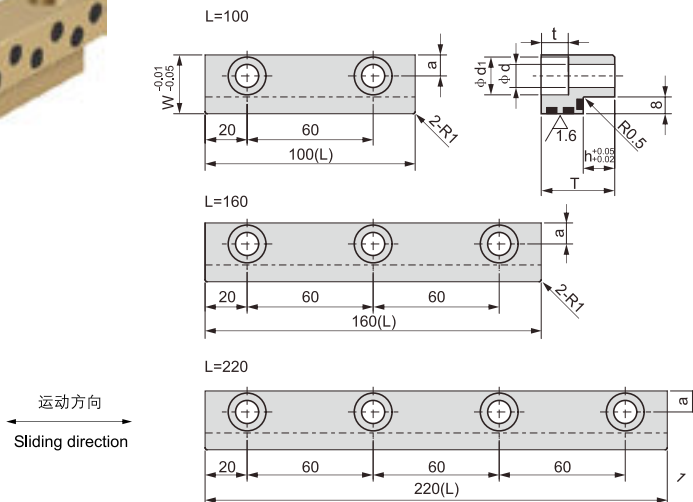

单位unit:mm

型号规格 Standard No.	W	L	T	a	d	d ₁	h	t
JGLDW-23x100	23	100	30	7.5	7	11	15	7
JGLDW-23x160		160						
JGLDW-23x220		220						
JGLDW-23x100		100	41				26	
JGLDW-23x160		160						
JGLDW-23x220		220						
JGLDW-28x100	28	100	25	10	11	18	10	13
JGLDW-28x160		160						
JGLDW-28x220		220						
JGLDW-28x100		100	35				15	
JGLDW-28x160		160						
JGLDW-28x220		220						
JGLDW-28x100	28	100	56	10	11	18	26	
JGLDW-28x160		160						
JGLDW-28x220		220						

自润滑和免维护滑动轴承

JTGLW 自润导轨 JTGLW Oilless Guide Rail



Material	600 # + Graphite
材质	高力黄铜 + 石墨

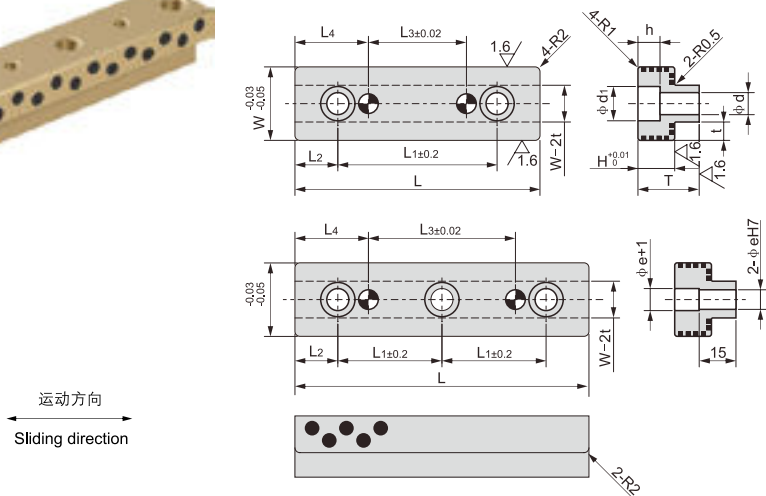

单位unit:mm

型号规格 Standard No.	W	L	L ₁	L ₂	L ₃	L ₄	T	H	t	d	d ₁	h	e H7	
JTGLW-20x60	20	60	35	12.5	15	22.5	15	8	4.5	5.5	9.5	6	6 ^{+0.012} ₀	
JTGLW-20x80		80	55		35									
JTGLW-20x100		100	75		55									
JTGLW-25x80	25	80	50	15	20	30	20	8	5.5	6.5	11	7		
JTGLW-25x100		100	70		40									30
JTGLW-25x120		120	45		60									
JTGLW-30x100	30	100	65	17.5	40	30	25	10	7.5	9	14	9	8 ^{+0.015} ₀	
JTGLW-30x120		120	42.5		60									
JTGLW-30x140		140	52.5		80									
JTGLW-40x120	40	120	40	20	40	40	30	15	11	11	18	11		
JTGLW-40x140		140	50		60									
JTGLW-40x160		160	60		80									
JTGLW-40x180		180	70		100									

JGLXS 自润滑板
JGLXS Oilless Wear Plate

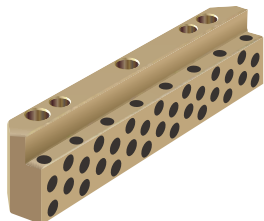

运动方向
Sliding direction

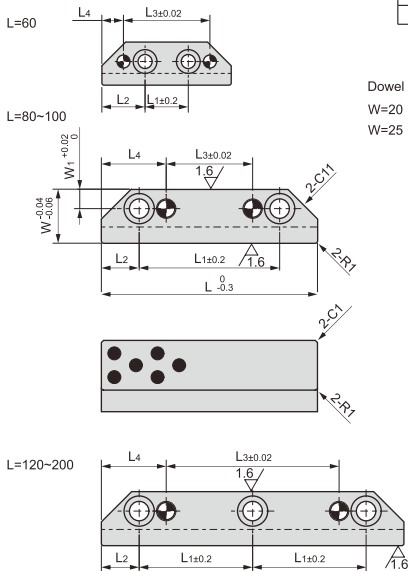

Material	600 # + Graphite
材质	高力黄铜 + 石墨

Dowel hole 定位销

W=20

$\phi 6^{+0.012}_0$

W=25 · 30

$\phi 8^{+0.015}_0$

单位unit:mm

型号规格 Standard No.	W	L	T	W ₁	L ₁	L ₂	L ₃	L ₄	H	t	r	
JGLXS-20x60xT	20	60	23		20	20	40	10	8	5.5	0.5	
JGLXS-20x80xT		80			20							
JGLXS-20x100xT		100			40							
JGLXS-20x120xT		120			45		15					60
JGLXS-20x140xT		140			55		80					
JGLXS-20x160xT	160	65	100									
JGLXS-25x80xT	25	80	28	9	45	17.5	20	30	10	7.5	0.8	
JGLXS-25x100xT		100			65		40					
JGLXS-25x120xT		120			42.5		60					
JGLXS-25x140xT		140			52.5		80					
JGLXS-25x160xT		160			62.5		100					
JGLXS-25x180xT		180			72.5		120					
JGLXS-25x200xT		200			82.5		140					
JGLXS-30x100xT	30	100	43	11	60	20	20	15	11			
JGLXS-30x120xT	30	120			40		40					
JGLXS-30x140xT	30	140			50		60					
JGLXS-30x160xT	30	160			60		80					
JGLXS-30x180xT	30	180			70		100					
JGLXS-30x200xT	30	200			80		120					

自润滑和免维护滑动轴承

JGLX 自润滑板 JGLX Oilless Wear Plate



Material	600 # + Graphite
材质	高力黄铜 + 石墨

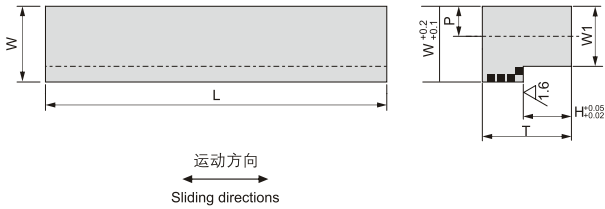

单位unit:mm

型号规格 Standard No.	W	L	T	W ₁	H	推荐安装孔 Recommended Mounting Hole	
						P	Size
JGLX-20 × 15	20	320	15	14.5	5	8	M8
JGLX-20 × 20			20				
JGLX-20 × 25			25				
JGLX-20 × 23			23				
JGLX-20 × 28			28				
JGLX-25 × 28	25	320	28	17.5	10	10	
JGLX-25 × 33			33				
JGLX-25 × 43			43				
JGLX-30 × 38	30	320	38	19	15	12	
JGLX-30 × 43			43				
JGLX-30 × 53			53				
JGLX-35 × 43	35	605	43	23	20	14	
JGLX-35 × 53			53				
JGLX-35 × 63			63				
JGLX-40 × 45	40	605	45	28	20	14	
JGLX-40 × 55			55				
JGLX-40 × 65			65				

JSOL 自润滑板
JSOL Oilless Wear Plate



Material	600 # + Graphite
材质	高力黄铜 + 石墨

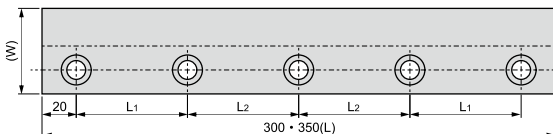
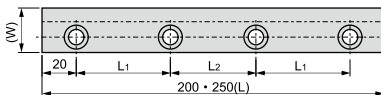
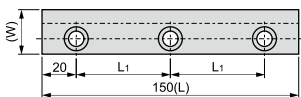
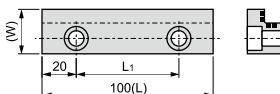
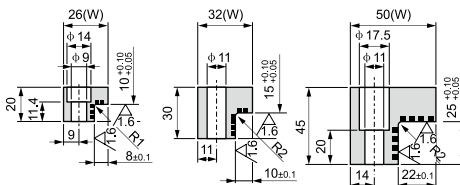

Sliding directions
运动方向

单位unit:mm

型号规格 Standard No.	W	L	螺栓孔位置 Bolt Position		螺栓孔 Mounting Bolt	
			L ₁	L ₁	尺寸 Size	数量 Quantity
JSOL-26 × 100	26	100	60	-	M8	2
JSOL-26 × 150		150	55	-		3
JSOL-26 × 200		200	55	50		4
JSOL-32 × 100	32	100	60	-	M10	2
JSOL-32 × 150		150	55	-		3
JSOL-32 × 200		200	55	50		4
JSOL-32 × 250	250	70	70			
JSOL-50 × 200	50	200	55	50		
JSOL-50 × 250		250	70	70		
JSOL-50 × 300		300	65	65		
JSOL-50 × 350		350	80	75		

自润滑和免维护滑动轴承

JFRP 自润滑板 JFRP Oilless Wear Plate



Matal 材质	S45C+Gr/石墨
Hardness 硬度	HRC≥40

W=48 · 75

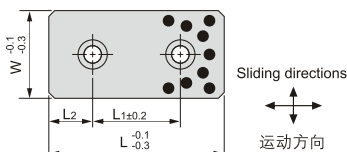

W≥100

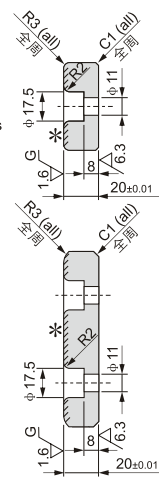
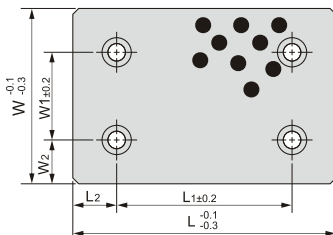

* Induction area
热处理区域

单位unit:mm

型号规格 Standard No.	W	L	W ₁	W ₂	L ₁	L ₂
JFRP-48 × 75	48	75	-	-	45	15
JFRP-48 × 100		100			50	
JFRP-48 × 125		125			75	
JFRP-48 × 150		150			100	
JFRP-48 × 200		200			150	
JFRP-75 × 75	75	75	-	-	25	25
JFRP-75 × 100		100			50	
JFRP-75 × 125		125			75	
JFRP-75 × 150		150			100	
JFRP-75 × 200		200			150	
JFRP-100 × 100	100	100	50	25	50	25
JFRP-100 × 125		125			75	
JFRP-100 × 150		150			100	
JFRP-100 × 200		200			150	
JFRP-100 × 250		250			200	
JFRP-125 × 125	125	125	-	37.5	75	25
JFRP-125 × 150		150			100	
JFRP-125 × 200		200			150	
JFRP-125 × 250		250			200	
JFRP-150 × 150		150			100	
JFRP-150 × 200	150	200	100	25	150	25
JFRP-150 × 250		250			200	

JESF 自润滑板
JESF Oilless Wear Plate



Matal 材质	S45C+Gr/石墨
Hardness 硬度	HRC≥40

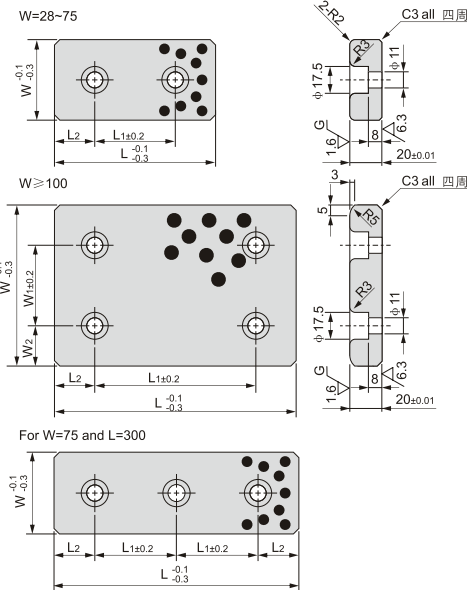

单位:mm

型号规格 Standard No.	W	L	W ₁	W ₂	L ₁	L ₂
JESF-28 × 75	28	75			45	15
JESF-28 × 100		100			50	25
JESF-28 × 125		125			75	
JESF-28 × 150		150			100	
JESF-28 × 200		200			150	
JESF-38 × 75	38	75			45	15
JESF-38 × 100		100			50	25
JESF-38 × 125		125			75	
JESF-38 × 150		150			100	
JESF-38 × 200		200			150	
JESF-48 × 75	48	75			45	15
JESF-48 × 100		100			50	25
JESF-48 × 125		125			75	
JESF-48 × 150		150			100	
JESF-48 × 200		200			150	
JESF-58 × 75	58	75			45	15
JESF-58 × 100		100			50	25
JESF-58 × 125		125			75	
JESF-58 × 150		150			100	
JESF-58 × 200		200			150	
JESF-75 × 75	75	75			25	25
JESF-75 × 100		100			50	
JESF-75 × 125		125			75	

型号规格 Standard No.	W	L	W ₁	W ₂	L ₁	L ₂
JESF-75 × 150	75	150			100	25
JESF-75 × 200		200			150	
JESF-75 × 250		250			200	
JESF-75 × 300		300			100	
JESF-100 × 100	100	100			50	25
JESF-100 × 125		125			75	
JESF-100 × 150		150			100	
JESF-100 × 200		200			150	
JESF-100 × 250		250			200	
JESF-100 × 300	300	200	50			
JESF-125 × 125	125	125			75	25
JESF-125 × 150		150			100	
JESF-125 × 200		200			150	
JESF-125 × 250		250			200	
JESF-125 × 300		300			200	
JESF-150 × 150	150	150			100	25
JESF-150 × 200		200			150	
JESF-150 × 250		250			200	
JESF-150 × 300		300			250	
JESF-200 × 200		200			200	
JESF-200 × 250	200	250			200	25
JESF-200 × 300		300			250	

自润滑和免维护滑动轴承

JSP 自润滑板 JSP Oilless Wear Plate



Material	600 # + Graphite
材质	高力黄铜 + 石墨

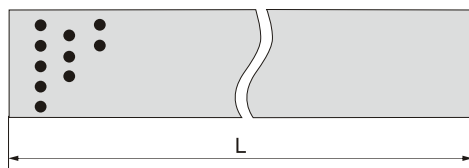
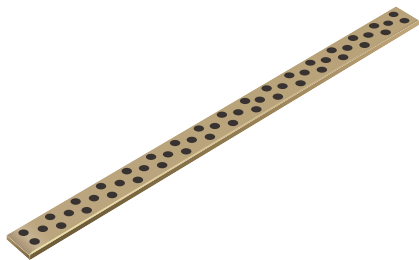

运动方向
Sliding directions

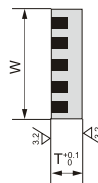

单位unit:mm

型号规格 Standard No.	W	T	L	推荐螺栓 Recommend bolt
JSP-20 × 5 × 305	20	5.3	305	沉头螺钉 M6 × 10 Countersunk head screw
JSP-25 × 5 × 305	25			
JSP-30 × 5 × 305	30		400	
JSP-30 × 5 × 400	30			
JSP-35 × 10 × 605	35	10.3	605	沉头螺钉 M8 × 15 Hex socket round head screw
JSP-40 × 10 × 605	40			
JSP-50 × 10 × 605	50			
JSP-60 × 15 × 605	60	15.3	605	沉头螺钉 M10 × 20 Hex socket bolt
JSP-80 × 15 × 605	80			
JSP-80 × 20 × 605	80	20.3	605	
JSP-100 × 20 × 605	100			

JGB 射出座导套 JGB Oilless Ejector Guide Bushings

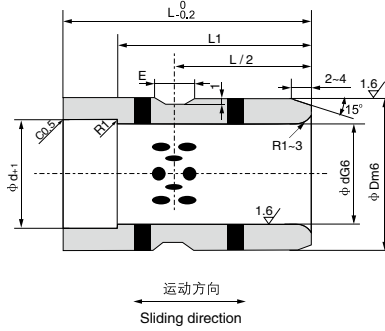

Material	600 # + Graphite
材质	高力黄铜 + 石墨

单位unit:mm

型号规格 Standard No.	d	L	d G6	D m6	L1	E	型号规格 Standard No.	d	L	d G6	D m6	L1	E
JGB-12 × 9	12	9	+0.017 +0.006	18	9	4	JGB-35 × 29	35	29	+0.025 +0.009	48	29	8
JGB-12 × 14	12	14			14		JGB-35 × 39	35	39			39	
JGB-12 × 19	12	19			19		JGB-35 × 49	35	49			49	
JGB-12 × 24	12	24	+0.021 +0.008	25	24	JGB-35 × 59	35	59	+0.025 +0.009	55	59	10	
JGB-16 × 14	16	14			14	JGB-35 × 69	35	69			69		
JGB-16 × 19	16	19			19	JGB-35 × 79	35	79			70		
JGB-16 × 24	16	24	+0.020 +0.007	30	24	JGB-40 × 39	40	39	+0.030 +0.011	70	39	10	
JGB-16 × 29	16	29			29	JGB-40 × 49	40	49			49		
JGB-16 × 34	16	34			34	JGB-40 × 59	40	59			59		
JGB-16 × 39	16	39	+0.025 +0.009	35	35	JGB-40 × 69	40	69	+0.029 +0.010	80	69	10	
JGB-20 × 14	20	14			14	JGB-40 × 79	40	79			80		
JGB-20 × 19	20	19			19	JGB-40 × 89	40	89			80		
JGB-20 × 24	20	24	+0.020 +0.007	30	24	JGB-50 × 49	50	49	+0.035 +0.013	100	49	10	
JGB-20 × 29	20	29			29	JGB-50 × 59	50	59			59		
JGB-20 × 34	20	34			34	JGB-50 × 69	50	69			69		
JGB-20 × 39	20	39	+0.025 +0.009	35	39	JGB-50 × 79	50	79	+0.029 +0.010	80	79	10	
JGB-20 × 49	20	49			40	JGB-50 × 89	50	89			89		
JGB-25 × 24	25	24			24	JGB-50 × 99	50	99			90		
JGB-25 × 29	25	29	+0.020 +0.007	35	29	JGB-60 × 59	60	59	+0.029 +0.010	80	59	10	
JGB-25 × 34	25	34			34	JGB-60 × 69	60	69			69		
JGB-25 × 39	25	39			39	JGB-60 × 79	60	79			79		
JGB-25 × 49	25	49	+0.025 +0.009	42	49	JGB-60 × 89	60	89	+0.035 +0.013	100	89	10	
JGB-25 × 59	25	59			50	JGB-60 × 99	60	99			90		
JGB-30 × 29	30	29			29	JGB-60 × 109	60	109			90		
JGB-30 × 34	30	34	+0.025 +0.009	42	34	JGB-80 × 69	80	69	+0.035 +0.013	100	69	10	
JGB-30 × 39	30	39			39	JGB-80 × 79	80	79			79		
JGB-30 × 49	30	49			49	JGB-80 × 89	80	89			89		
JGB-30 × 59	30	59	+0.029 +0.010	42	59	JGB-80 × 99	80	99	+0.035 +0.013	100	99	10	
JGB-30 × 69	30	69			60	JGB-80 × 109	80	109			100		
JGB-30 × 79	30	79			60	JGB-80 × 119	80	119			100		

自润滑和免维护滑动轴承

JGBF 自润滑翻边导向套 JGBF Oilless Ejector Guide Bushings



Material	600 # + Graphite
材质	高力黄铜 + 石墨

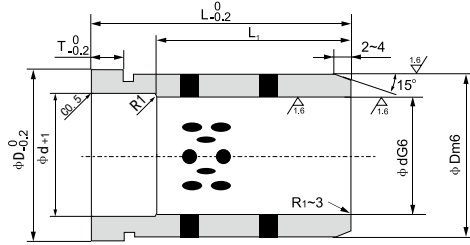

运动方向
Sliding direction

单位unit:mm

型号规格 Standard No.	d	L	d G6	D m6	D ₁	T	L ₁
JGBF-12 × 19	12	19					19
JGBF-12 × 24	12	24					24
JGBF-12 × 29	12	29		18	+0.018 +0.007	25	4
JGBF-12 × 34	12	34					34
JGBF-16 × 19	16	19					19
JGBF-16 × 24	16	24					24
JGBF-16 × 29	16	29	+0.016 +0.006	25		30	6
JGBF-16 × 34	16	34					30
JGBF-16 × 39	16	39					30
JGBF-16 × 49	16	49					30
JGBF-20 × 24	20	24					24
JGBF-20 × 29	20	29					29
JGBF-20 × 34	20	34		30	+0.025 +0.009	35	
JGBF-20 × 39	20	39					40
JGBF-20 × 49	20	49					40
JGBF-20 × 59	20	59					40
JGBF-25 × 24	25	24				8	24
JGBF-25 × 29	25	29					29
JGBF-25 × 34	25	34					34
JGBF-25 × 39	25	39		35		40	39
JGBF-25 × 49	25	49	+0.020 +0.007				49
JGBF-25 × 59	25	59					50
JGBF-25 × 69	25	69					50
JGBF-30 × 29	30	29					29
JGBF-30 × 34	30	34					34
JGBF-30 × 39	30	39					39
JGBF-30 × 49	30	49		42		47	10
JGBF-30 × 59	30	59					59
JGBF-30 × 69	30	69					60
JGBF-30 × 79	30	79					60

型号规格 Standard No.	d	L	d G6	D m6	D ₁	T	L ₁
JGBF-35 × 39	35	39					39
JGBF-35 × 49	35	49					49
JGBF-35 × 59	35	59					59
JGBF-35 × 69	35	69	35	48	+0.025 +0.009	54	69
JGBF-35 × 79	35	79					70
JGBF-35 × 89	35	89					70
JGBF-35 × 99	35	99					70
JGBF-40 × 39	40	39					10
JGBF-40 × 49	40	49					49
JGBF-40 × 59	40	59					59
JGBF-40 × 69	40	69					69
JGBF-40 × 79	40	79	40	55		61	79
JGBF-40 × 89	40	89					80
JGBF-40 × 99	40	99					80
JGBF-50 × 49	50	49					49
JGBF-50 × 59	50	59					59
JGBF-50 × 69	50	69					69
JGBF-50 × 79	50	79	50	70	+0.030 +0.011	76	12
JGBF-50 × 89	50	89					89
JGBF-50 × 99	50	99					90
JGBF-50 × 109	50	109					90
JGBF-50 × 119	50	119					90
JGBF-60 × 99	60	99					99
JGBF-60 × 109	60	109					109
JGBF-60 × 119	60	119	60	80	+0.029 +0.010	86	15
JGBF-60 × 129	60	129					110
JGBF-60 × 149	60	149					110

DIN9834 自润导套
DIN9834 Oilless Guide Bushes

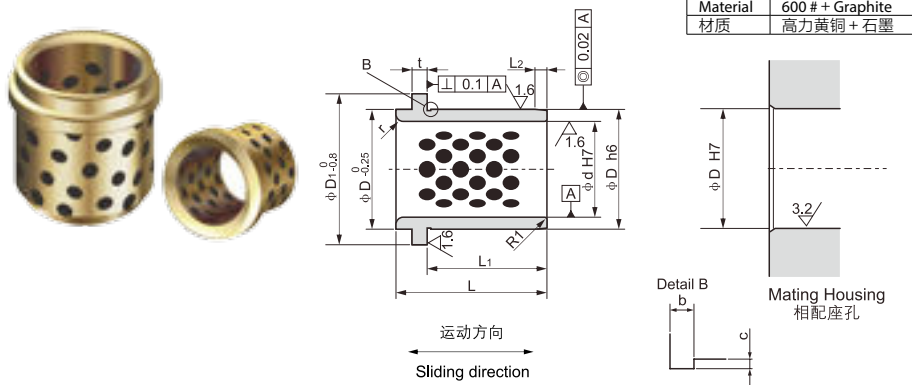

单位unit:mm

型号规格 Standard No.	d H7	D h6	L	D ₁	L ₁	L ₂	t	r	bxc	P	
DIN9834-025	25	^{+0.021} / ₀	32		40	40	30	3		58	
DIN9834-032	32		40	⁰ / _{-0.016}	50	50	40	4	6.3	3	66
DIN9834-040	40	^{+0.025} / ₀	50		63	63	50	5		0.6x0.3	79
DIN9834-050	50		63	⁰ / _{-0.019}	71	71	56	6.3		5	89
DIN9834-063	63		80	⁰ / _{-0.022}	80	90	63	8		6	123
DIN9834-080	80	^{+0.030} / ₀	100	⁰ / _{-0.025}	100	112	80	10		8	143
DIN9834-100	100		125	⁰ / _{-0.029}	125	140	106	12.5	10	10	168
DIN9834-125	125	^{+0.040} / ₀	160		160	180	132	16		12	203
DIN9834-160	160		200		200	220	170	16		18	243

Clamp VDI-KL(DIN9834)

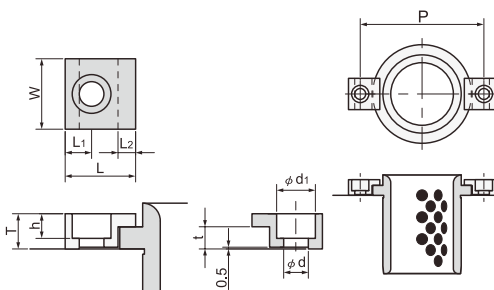

单位unit:mm

型号规格 Standard No.	W	L	T	L ₁	L ₂	t	d	d ₁	h	适用的轴套内孔尺寸 Applicable bushes ID
VDI-KL-6	20	20	10	7.5	5	6.3	7	11	7	Ø25~Ø50
VDI-KL-10	32	32	16	11	10	10	11.5	17.5	11.5	Ø63~Ø160

JOST 自润滑翻边导向套 JOST Oilless Flanged Guide Bushes

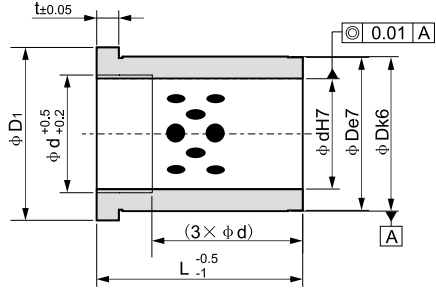

单位unit:mm

型号规格 Standard No.	d	L	t	D	公差 Tolerance		D ₁	dH7
					e7	k6		
JOST-9x12	12							
JOST-9x17	17						9	
JOST-9x22	22	9						
JOST-9x27	27							
JOST-9x36	36							
JOST-10x12	12		3	14			16	+0.015 0
JOST-10x17	17				-0.032 -0.050	+0.012 +0.001	10	
JOST-10x22	22	10						
JOST-10x27	27							
JOST-10x36	36							
JOST-12x17	17							
JOST-12x22	22						23	12
JOST-12x27	27	12		18				
JOST-12x36	36							
JOST-14x17	17							
JOST-14x22	22							
JOST-14x27	27						14	
JOST-14x36	36	14						
JOST-14x46	46		6					+0.018 0
JOST-14x56	56							
JOST-17x17	17			20	-0.040 -0.061	+0.015 +0.002	25	
JOST-17x22	22							
JOST-17x27	27						25	
JOST-17x36	36	17						
JOST-17x46	46							
JOST-17x56	56							

型号规格 Standard No.	d	L	t	D	公差 Tolerance		D ₁	dH7
					e7	k6		
JOST-16x17	17							
JOST-16x22	22							
JOST-16x27	27						27	16
JOST-16x36	36	16		22				
JOST-16x46	46							
JOST-16x56	56							
JOST-18x17	17							+0.018 0
JOST-18x22	22							
JOST-18x27	27							
JOST-18x36	36			18	-0.040 -0.061	+0.015 +0.002	18	
JOST-18x46	46		6					
JOST-18x56	56							
JOST-18x66	66						31	
JOST-20x17	17			26				
JOST-20x22	22							
JOST-20x27	27							
JOST-20x36	36	20					20	+0.021 0
JOST-20x46	46							
JOST-20x56	56							
JOST-20x66	66							

JOST 自润滑翻边导向套
JOST Oilless Flanged Guide Bushes



Material	600 # + Graphite
材质	高力黄铜 + 石墨

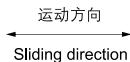

单位unit:mm

型号规格 Standard No.	d	L	t	D	公差 Tolerance		D ₁	d H7
					e7	k6		
JOST-22x22		22						
JOST-22x27		27						
JOST-22x36		36						
JOST-22x46	22	46					22	
JOST-22x56		56						
JOST-22x66		66						
JOST-22x76		76						
JOST-22x86		86						
JOST-24x17		17		30	-0.040	+0.015	35	
JOST-24x22		22			-0.061	+0.002		
JOST-24x27		27						
JOST-24x36		36					24	
JOST-24x46	24	46					24	+0.021
JOST-24x56		56						0
JOST-24x66		66						
JOST-24x76		76						
JOST-24x86		86						
JOST-30x27		27	6					
JOST-30x36		36						
JOST-30x46		46						
JOST-30x56		56						
JOST-30x66	30	66					30	
JOST-30x76		76						
JOST-30x86		86						
JOST-30x96		96						
JOST-30x116	116							
JOST-32x27		27		42	-0.050	+0.018	47	
JOST-32x36		36			-0.075	+0.002		
JOST-32x46		46						
JOST-32x56		56						
JOST-32x66	32	66					32	+0.025
JOST-32x76		76						0
JOST-32x86		86						
JOST-32x96		96						
JOST-32x116		116						

型号规格 Standard No.	d	L	t	D	公差 Tolerance		D ₁	d H7
					e7	k6		
JOST-40x56	56							
JOST-40x66	66							
JOST-40x76	76							
JOST-40x86	40	86					40	
JOST-40x96		96						
JOST-40x116		116						
JOST-40x136		136						
JOST-40x156		156						
JOST-42x56	56		54			60		
JOST-42x66	66							
JOST-42x76	76							
JOST-42x86	42	86	10			42	+0.025	
JOST-42x96		96					0	
JOST-42x116		116			-0.060	+0.021		
JOST-42x136		136			-0.090	+0.002		
JOST-42x156		156						
JOST-50x76	76							
JOST-50x86	86							
JOST-50x96	96							
JOST-50x116	50	116	66			72	50	
JOST-50x136		136						
JOST-50x156		156						
JOST-50x196		196						
JOST-60x96	96							
JOST-60x116	116							
JOST-60x136	60	136	20	80		86	+0.030	
JOST-60x156		156					0	
JOST-60x196		196						

GB71 日系汽车模具标准导套 GB71 NAAMS Standard Guide Bushing



Material	600 # + Graphite
材质	高力黄铜 + 石墨

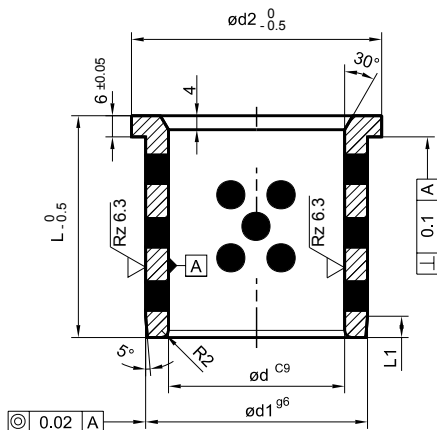

单位unit:mm

产品代号 Standard No.	NAAMS Code	d	d1	d2	L	L1
GB71 2540	G712540	25	32	40	40	4
GB71 3250	G713250	32	40	50	50	4
GB71 4055	G714055	40	50	63	55	5
GB71 5063	G715063	50	63	71	63	6
GB71 6375	G716375	63	80	90	75	8
GB71 8090	G718090	80	100	112	90	10
GB71 100115	G711011	100	125	140	115	12
GB71 125138	G711213	125	160	180	138	12

GB61 日系汽车模具标准导套
GB61 NAAMS Standard Guide Bushing

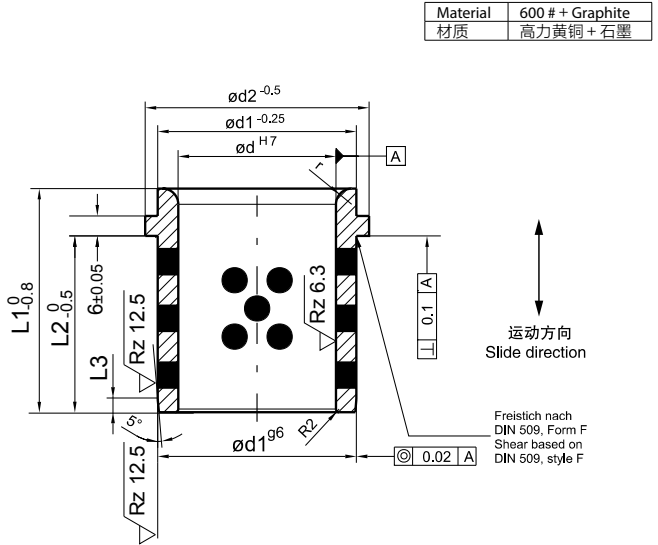

单位unit:mm

产品代号 Standard No.	NAAMS Code	d	d1	d2	L1	L2	L3	r
GB61 2540	G612540	25	32	40	40	30	4	3
GB61 3250	G613250	32	40	50	50	40	4	3
GB61 4063	G614063	40	50	63	63	50	5	3
GB61 5071	G615071	50	63	71	71	56	6	5
GB61 6380	G616380	63	80	90	80	63	8	6
GB61 80100	G618010	80	100	112	100	80	10	8
GB61 10125	G611012	100	125	140	125	106	12	10
GB61 115140	G611114	115	140	155	140	120	12	10
GB61 125160	G611216	125	160	180	160	132	12	12

自润滑和免维护滑动轴承

JEGB / JEGBK 塑胶模射出座导套 JEGB / JEGBK Oilless Ejector Guide Bushing



Material	600 # + Graphite
材质	高力黄铜 + 石墨

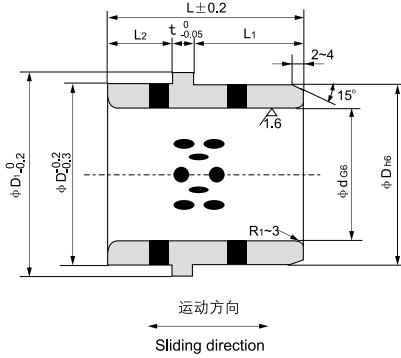

单位unit:mm

型号规格 Standard No.	d	L	d G6	D h6	D ₁	L ₁	L ₂	t
JEGB-16 × 26	16	26					12	
JEGB-16 × 28	16	28					14	
JEGB-16 × 33	16	33	+0.017 +0.006	25		30	19	
JEGB-16 × 38	16	38			0		24	
JEGB-20 × 26	20	26			0		12	
JEGB-20 × 28	20	28			-0.013		14	
JEGB-20 × 33	20	33				35	19	10
JEGB-20 × 38	20	38					24	
JEGB-25 × 26	25	26	+0.020 +0.007				12	
JEGB-25 × 28	25	28					14	
JEGB-25 × 33	25	33				40	19	4
JEGB-25 × 38	25	38					24	
JEGB-30 × 33	30	33			0		14	
JEGB-30 × 38	30	38			-0.016		19	
JEGB-30 × 46	30	43				45	24	15
JEGB-35 × 38	35	38					19	
JEGB-35 × 43	35	43				50	24	
JEGB-35 × 48	35	48					29	
JEGB-40 × 48	40	48	+0.025 +0.009	52			24	
JEGB-40 × 53	40	53			0		29	
JEGB-50 × 48	50	48			-0.019		24	20
JEGB-50 × 53	50	53				62	29	

型号规格 Standard No.	d	L	d G6	D h6	D ₁	L ₁	L ₂	t
JEGBK-25 × 33	25	33					19	6
JEGBK-25 × 38	25	38					24	6
JEGBK-30 × 48	30	48	+0.020 +0.006	40			29	11
JEGBK-30 × 47	30	47					24	15
JEGBK-30 × 52	30	52			0		29	15
JEGBK-35 × 63	35	63			-0.016		39	16
JEGBK-40 × 60	40	60					32	20
JEGBK-40 × 70	40	70					42	20
JEGBK-40 × 78	40	78					49	21
JEGBK-40 × 57	40	57					24	25
JEGBK-40 × 67	40	67	+0.017 +0.006	55			29	30
JEGBK-45 × 88	45	88					59	21
JEGBK-45 × 95	45	95					69	21
JEGBK-50 × 67	50	67			0		29	30
JEGBK-50 × 87	50	87			-0.019		39	40
JEGBK-60 × 67	60	67					29	30
JEGBK-60 × 87	60	87	+0.017 +0.006	74			39	40

JOSG 射出头自润导套
JOSG Ejector Guide Bushing

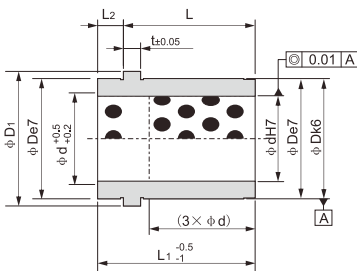

Material	600 # + Graphite
材质	高力黄铜 + 石墨

运动方向
Sliding direction

单位unit:mm

型号规格 Standard No.	d	L	L ₁	L ₂	t	公差 Tolerance		D ₁	L ₁
						e7	k6		
JOSG-9×15	12	15							
JOSG-9×20	17	20							
JOSG-9×25	9	22	25					9	
JOSG-9×30	27	30							
JOSG-9×39	36	39							
JOSG-10×15	12	15	3	3	14	-0.032	+0.012	16	+0.015
JOSG-10×20	17	20				-0.050	+0.001		0
JOSG-10×25	10	22	25					10	
JOSG-10×30	27	30							
JOSG-10×39	36	39							
JOSG-14×26	17	26							
JOSG-14×31	22	31							
JOSG-14×36	14	27	36					14	
JOSG-14×45	36	45							
JOSG-14×55	46	55							
JOSG-14×65	56	65							
JOSG-15×26	17	26						25	
JOSG-15×31	22	31							
JOSG-15×36	27	36							
JOSG-15×45	15	36	45					15	+0.018
JOSG-15×55	46	55							0
JOSG-15×65	56	65							
JOSG-18×26	17	26							
JOSG-18×31	22	31							
JOSG-18×36	27	36							
JOSG-18×45	18	36	45					18	
JOSG-18×55	46	55							
JOSG-18×65	56	65							
JOSG-18×75	66	75							
JOSG-20×26	17	26						31	
JOSG-20×31	22	31							
JOSG-20×36	27	36							
JOSG-20×45	20	36	45					20	
JOSG-20×55	46	55							
JOSG-20×65	56	65							
JOSG-20×75	66	75							
JOSG-22×26	17	26							
JOSG-22×31	22	31							
JOSG-22×36	27	36							
JOSG-22×45	36	45							
JOSG-22×55	22	46	55					35	22
JOSG-22×65	56	65							
JOSG-22×75	66	75							
JOSG-22×85	76	85							
JOSG-22×95	86	95							

型号规格 Standard No.	d	L	L ₁	L ₂	t	公差 Tolerance		D ₁	L ₁
						e7	k6		
JOSG-24×26	17	26							
JOSG-24×31	22	31							
JOSG-24×36	27	36							
JOSG-24×45	36	45							
JOSG-24×55	24	46	55					35	24
JOSG-24×65	56	65				-0.040	+0.015		
JOSG-24×75	66	75				-0.061	+0.002		
JOSG-24×85	76	85							
JOSG-24×95	86	95							+0.021
JOSG-30×36	27	36							0
JOSG-30×45	36	45							
JOSG-30×55	46	55							
JOSG-30×65	56	65							
JOSG-30×75	30	66	75	9	6			30	
JOSG-30×85	76	85							
JOSG-30×95	86	95							
JOSG-30×105	96	105							
JOSG-30×125	116	125							
JOSG-32×36	27	36							
JOSG-32×45	36	45							
JOSG-32×55	46	55							
JOSG-32×65	56	65							
JOSG-32×75	32	66	75					32	
JOSG-32×85	76	85							
JOSG-32×95	86	95							
JOSG-32×105	96	105							
JOSG-32×125	116	125							
JOSG-40×68	56	68							
JOSG-40×78	66	78							
JOSG-40×88	76	88							
JOSG-40×98	86	98							+0.025
JOSG-40×108	40	96	108					40	0
JOSG-40×128	116	128							
JOSG-40×148	136	148							
JOSG-40×168	156	168							
JOSG-42×68	56	68							
JOSG-42×78	66	78							
JOSG-42×88	76	88							
JOSG-42×98	86	98							
JOSG-42×108	42	96	108					42	
JOSG-42×128	116	128							
JOSG-42×148	136	148							
JOSG-42×168	156	168							

自润滑和免维护滑动轴承

JOVL 自润滑板 JOVL Oilless Wear Plate

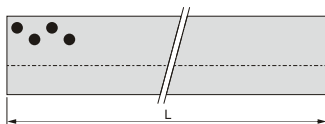

Material	600 # + Graphite
材质	高力黄铜 + 石墨

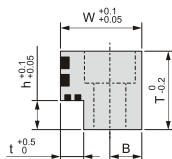

单位unit:mm

型号规格 Standard No.	L	W	T	h	t	B
JOVL-01	205	15	12	5		6
JOVL-02	205		17		5	
JOVL-03	320	20		7		7.5
JOVL-04	205		22			
JOVL-05	320					
JOVL-06	205					
JOVL-07	320		27			
JOVL-08	605	28		10	8	11
JOVL-09	205					
JOVL-10	320		36			
JOVL-11	605					

型号规格 Standard No.	L	W	T	h	t	B
JOVL-12	205					
JOVL-13	320	28	46	10	8	11
JOVL-14	605					
JOVL-15	205					
JOVL-16	320		66	22		
JOVL-17	605	40			12	14
JOVL-18	205					
JOVL-19	320		86	26		
JOVL-20	605					

JGBX 自润滑板 JGBX Oilless Wear Plate

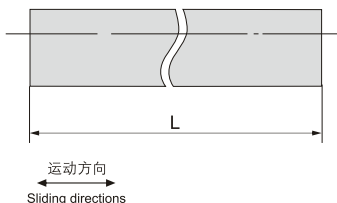

Material	600 # + Graphite
材质	高力黄铜 + 石墨

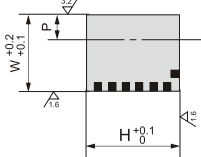

单位unit:mm

型号规格 Standard No.	W	H	L	螺栓 Recom.bolt	
				P	规格 Size
JGBX-20 × 10		10			
JGBX-20 × 15	20	15	320		
JGBX-20 × 20		20			
JGBX-25 × 18		18			
JGBX-25 × 23	25	23		10	M8
JGBX-25 × 33		33			
JGBX-30 × 23		23			
JGBX-30 × 28	30	28			
JGBX-30 × 38		38			

型号规格 Standard No.	W	H	L	螺栓 Recom.bolt	
				P	规格 Size
JGBX-35 × 28		28			
JGBX-35 × 38	35	38		12	M10
JGBX-35 × 48		48			
JGBX-40 × 28		28	605		
JGBX-40 × 38	40	38		14	M12
JGBX-40 × 48		48			

JGL 自润滑板
JGL Oilless Wear Plate



Material	600 # + Graphite
材质	高力黄铜 + 石墨

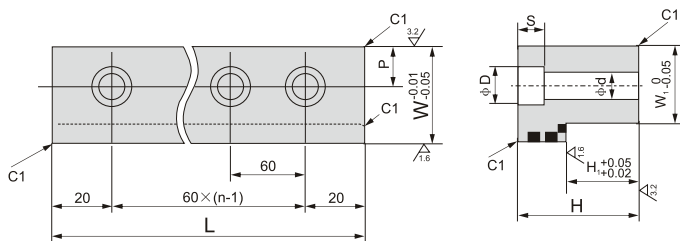

单位unit:mm

型号规格 Standard No.	W	W ₁	L	H	H ₁	n	p	ΦD	Φd	S
JGL-100 × 30	23	15	100	30	15	2	7.5	11	7	7
JGL-160 × 30			160			3				
JGL-200 × 30			220			4				
JGL-100 × 41	23	15	100	41	26	2	7.5	11	7	7
JGL-160 × 41			160			3				
JGL-200 × 41			220			4				
JGL-100 × 25	28	20	100	25	10	2	10	18	11	13
JGL-160 × 25			160			3				
JGL-200 × 25			220			4				
JGL-100 × 35	28	20	100	35	15	2	10	18	11	13
JGL-160 × 35			160			3				
JGL-200 × 35			220			4				
JGL-100 × 56	28	20	100	56	26	2	10	14	9	10
JGL-160 × 56			160			3				
JGL-200 × 56			220			4				

自润滑和免维护滑动轴承

JCGBF, JCGBW 自润滑板 JCGBF, JCGBW Oilless Wear Plate

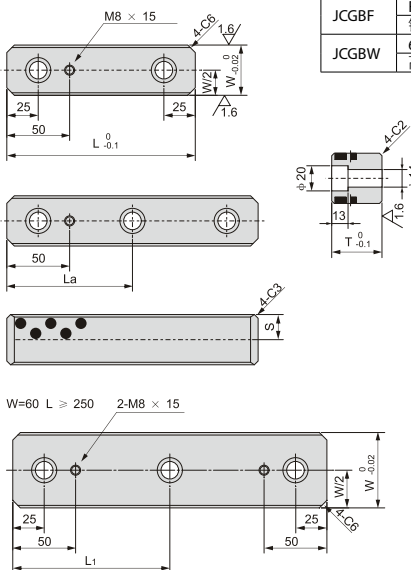

JCGBF	FC250 # + Graphite 铸铁 + 石墨
JCGBW	600 # + Graphite 高力黄铜 + 石墨

单位unit:mm

型号规格 Standard No.	材料 Material	W	L	T	L ₁	S
30 × 100 × 30	JCGBF	30	100	30	-	15
30 × 150 × 30			150		-	
30 × 200 × 30			200		100	
30 × 250 × 30			250		125	
30 × 300 × 30			300		150	
30 × 350 × 30			350		175	
40 × 100 × 30	JCGBF	40	100	30	-	15
40 × 150 × 30			150		-	
40 × 200 × 30			200		100	
40 × 250 × 30			250		125	
40 × 300 × 30			300		150	
40 × 350 × 30			350		175	
30 × 100 × 40	JCGBF JCGBW	40	100	40	-	20
30 × 150 × 40			150		-	
30 × 200 × 40			200		100	
30 × 250 × 40			250		125	
30 × 300 × 40			300		150	
30 × 350 × 40			350		175	
40 × 100 × 40	JCGBW	60	100	40	-	25
40 × 250 × 40			250		125	
40 × 300 × 40			300		150	
40 × 350 × 40			350		175	

JVSOL 自润滑板
JVSOL Oilless Wear Plate



Material	600 # + Graphite
材质	高力黄铜 + 石墨

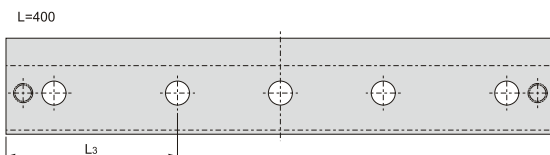
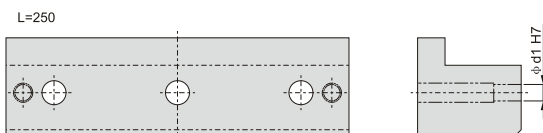
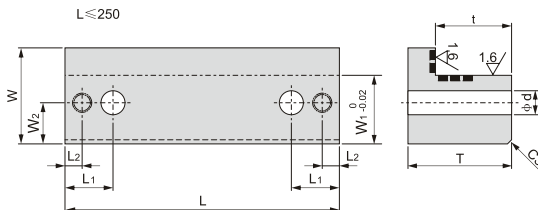

Sliding directions
运动方向

单位unit:mm

型号规格 Standard No.	W	L	W ₁	W ₂	L ₁	L ₂	L ₃	T	t	d	d ₁
JVSOL-25 × 125	25	125	18	9				15.5	8.5	9	6
JVSOL-25 × 160		160									
JVSOL-32 × 125	32	125	22	11	27.5	10		30.5	15.5	11	8
JVSOL-32 × 160		160									
JVSOL-32 × 200		200									
JVSOL-55 × 100	55	100	37	20				55.5	39.5	13.5	10
JVSOL-55 × 160		160									
JVSOL-70 × 160	70	160	50	30	35	12.5		75.5	55.5	17.5	12
JVSOL-70 × 200		200									
JVSOL-70 × 250		250									
JVSOL-70 × 400		400									
JVSOL-85 × 160	85	160	63	38	42.5	15		90.5	65.5	22	16
JVSOL-85 × 200		200									
JVSOL-85 × 250		250									
JVSOL-85 × 400		400									

自润滑和免维护滑动轴承

JCUW/JCUF/JCUS 自润滑板 JCUW/JCUF/JCUS Oilless Wear Plate



Sliding directions
运动方向

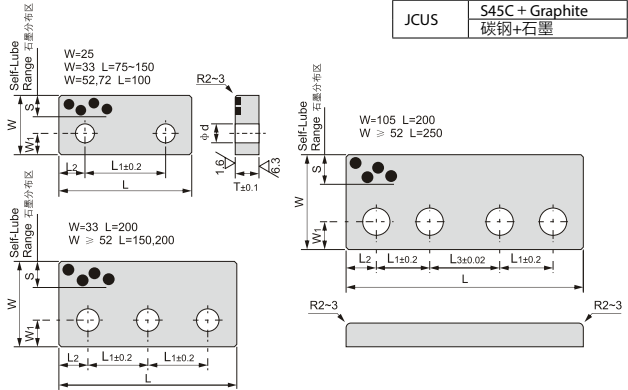

JCUF	FC250 # + Graphite 铸铁 + 石墨
JCUW	600 # + Graphite 高力黄铜 + 石墨
JCUS	S45C + Graphite 碳钢 + 石墨

单位unit:mm

型号规格 Standard No.	材料 Material	W	L	T	L ₁	L ₂	L ₃	W ₁	s	d	螺孔数Bolt Hole Q'ty
25 × 75	JCUW	25	75	10	45	15	-	8	7.5	9	2
25 × 100			100		50	25					
25 × 125			125		75	25					
33 × 75	JCUW	33	75	10	45	15	-	12.5	9	11	2
33 × 100			100		50						
33 × 125			125		75						
33 × 150			150		100						
33 × 200	JCUW JCUF JCUS	52	200	20	75	15	50	20	13	13	3
52 × 100			100		50	2					
52 × 150			150		50	3					
52 × 200			200		75	4					
52 × 250	JCUW JCUF JCUS	72	250	30	75	25	50	22	27	18	4
72 × 100			100		50	2					
72 × 150			150		50	3					
72 × 200			200		75	4					
72 × 250	JCUW JCUF JCUS	77	250	35	75	50	50	25	32	18	4
77 × 150			150		50	3					
77 × 200			200		75	4					
77 × 250			250		75	4					
82 × 150	JCUW JCUF JCUS	82	150	40	50	50	50	25	32	18	3
82 × 200			200		75	3					
82 × 250			250		75	4					
105 × 150	JCUW JCUF	105	150	40	50	50	50	25	32	18	3
105 × 200			200		50	4					
105 × 250			250		75	4					

JCSRG, JCSRW 自润滑板
JCSRG, JCSRW Oilless Wear Plate

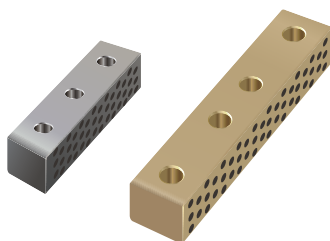

JCSRG	FC250 # + Graphite 铸铁 + 石墨
JCSRW	600 # + Graphite 高力黄铜 + 石墨

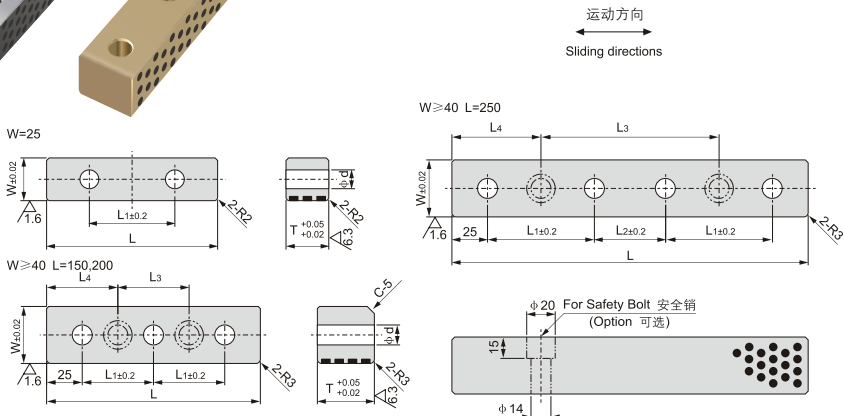

单位unit:mm

型号规格 Standard No.	材料 Material	W	L	L ₃	L ₄	T	L ₁	L ₂	d		
25 × 75 × 25	JCSRG	25	75	-	-	25	45	-	11		
25 × 100 × 25			100				50				
25 × 125 × 25			125				75				
25 × 150 × 25			150				100				
40 × 150 × 30	JCSRG JCSRW	40	150	50	50	30	50	-	14		
40 × 200 × 30			200	75	62.5		75				
40 × 250 × 30			250	125	62.5		75			50	
40 × 150 × 40			150	50	50		50			-	
40 × 200 × 40			200	75	62.5		40			75	-
40 × 250 × 40	250	125	62.5	75	50						
50 × 150 × 45	JCSRG JCSRW	50	150	50	50	45	50	-	20		
50 × 200 × 45			200	75	62.5		75				
50 × 250 × 45			250	125	62.5		75			50	
50 × 150 × 55			150	50	50		50			-	
50 × 200 × 55			200	75	62.5		55			75	-
50 × 250 × 55			250	125	62.5		75			50	
50 × 150 × 60			150	50	50		60			50	-
50 × 200 × 60			200	75	62.5		75			-	
50 × 250 × 60			250	125	62.5		75			50	
50 × 150 × 70			150	50	50		70			50	-
50 × 200 × 70			200	75	62.5		75			-	
50 × 250 × 70			250	125	62.5		75			50	

自润滑和免维护滑动轴承

JVG2 自润滑板 JVG2 Oilless Wear Plate

Material	600 # + Graphite
材质	高力黄铜 + 石墨



Sliding directions
运动方向

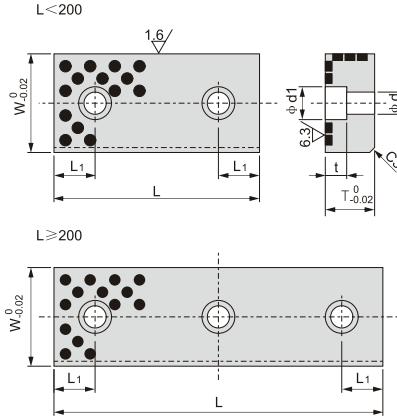

单位unit:mm

型号规格 Standard No.	W	L	T	L ₁	d	d ₁	t	Recommend mounting bolt DIN EN ISO4762
JVG2 25 × 110 × 12	25	110	12	25	9	15	8.5	M8 × 20
JVG2 25 × 120 × 12		120						
JVG2 25 × 110 × 15		110	15					
JVG2 25 × 120 × 15		120						
JVG2 60 × 125 × 30	60	125	30		13.5	20	13	M12 × 35
JVG2 60 × 160 × 30		160						
JVG2 60 × 200 × 30		200						
JVG2 60 × 125 × 40		125	40					
JVG2 60 × 160 × 40		160						
JVG2 60 × 200 × 40		200						

JSOD 自润滑板
JSOD Oilless Wear Plate



Material	600 # + Graphite
材质	高力黄铜 + 石墨

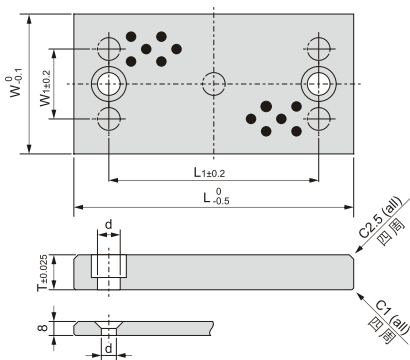
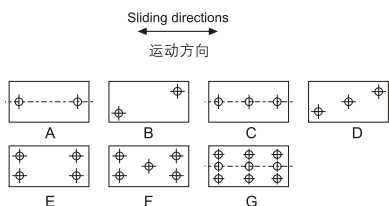
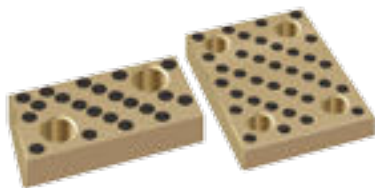

单位unit:mm

型号规格 Standard No.	T	W	W ₁	L ₁	L	螺栓数量 Screw Q'ty	Mounting Bolt	螺孔排布 Hole Pattern
JSOD 8 × 40 × 100	8	40	-	60	100	2	M8	A
JSOD 8 × 40 × 160				120	160	2		A
JSOD 8 × 40 × 250				210	250	3		C
JSOD 12 × 30 × 100	12	30	-	60	100	2	M8	A
JSOD 12 × 30 × 160				120	160	2		A
JSOD 12 × 30 × 250				210	250	3		C
JSOD 12 × 40 × 100	12	40	-	60	100	2	M8	A
JSOD 12 × 40 × 160				120	160	2		A
JSOD 12 × 40 × 250				210	250	3		C
JSOD 12 × 80 × 100	12	80	40	60	100	2	M8	B
JSOD 12 × 80 × 160				120	160	4		E
JSOD 12 × 80 × 250				210	250	5		F
JSOD 16 × 40 × 100	16	40	-	60	100	2	M10	A
JSOD 16 × 40 × 160				120	160	2		A
JSOD 16 × 40 × 250				210	250	3		C
JSOD 16 × 60 × 100	16	60	30	60	100	2	M10	B
JSOD 16 × 60 × 160				120	160	2		B
JSOD 16 × 60 × 250				210	250	3		D
JSOD 16 × 100 × 100	16	100	60	60	100	2	M10	B
JSOD 16 × 100 × 160				120	160	4		E
JSOD 16 × 100 × 250				210	250	6		G
JSOD 20 × 50 × 100	20	50	20	60	100	2	M12	B
JSOD 20 × 50 × 160				120	160	2		B
JSOD 20 × 50 × 250				210	250	3		D
JSOD 20 × 80 × 100	20	80	40	60	100	2	M12	B
JSOD 20 × 80 × 160				120	160	4		E
JSOD 20 × 80 × 250				210	250	5		F
JSOD 20 × 125 × 100	20	125	85	60	100	4	M12	E
JSOD 20 × 125 × 160				120	160	4		E
JSOD 20 × 125 × 250				210	250	6		G

自润滑和免维护滑动轴承

JSOVP 自润滑板 JSOVP Oilless Wear Plate



Material	600 # + Graphite
材质	高力黄铜 + 石墨

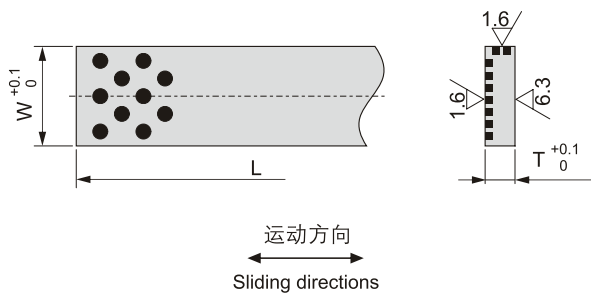

单位unit:mm

型号规格 Standard No.	d	W	T
JSOVP-25 × 305 × 5	305	25	5.3
JSOVP-25 × 305 × 6		30	6.3
JSOVP-40 × 605 × 8	605	40	8.3
JSOVP-35 × 605 × 10		35	10.3
JSOVP-50 × 605 × 10		50	10.3
JSOVP-40 × 605 × 12		40	12.3
JSOVP-80 × 605 × 12		80	12.3
JSOVP-60 × 605 × 16		60	16.3
JSOVP-80 × 605 × 20		80	20.3
JSOVP-100 × 605 × 20		100	20.3

JEFW 自润滑导套
JEFW Guide Bushes

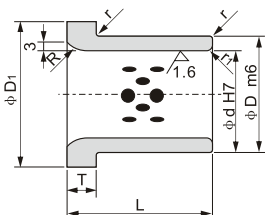

Material	600 # + Graphite
材质	高力黄铜 + 石墨



单位unit:mm

型号规格 Standard No.	d	L	d	h7	D	m ₆	D ₁	T	R	r1	r ₁
JEFW-25 × 40	25	40	25	+0.021	35	+0.025	45	7	10	1	
JEFW-30 × 50	30	50	30	0	40	+0.009	50	10			
JEFW-40 × 70	40	70	40	+0.025	55	+0.030	65	10	20	2	
JEFW-50 × 80	50	80	50	0	65		+0.011				
JEFW-60 × 80	60	80	60	+0.030	75		85	10	20	2	
JEFW-65 × 80	65	80	65		80		90				
JEFW-65 × 120	65	120	65	0	80		90				
JEFW-80 × 100	80	100	80	+0.035	100	+0.013	110				
JEFW-80 × 140	80	140	80		100		110				
JEFW-100 × 100	100	100	100	0	120		130				
JEFW-100 × 140	100	140	100	0	120		130				

JPBW,JPBF 自润滑轴套
JPBW,JPBF Oilless Wear Plate

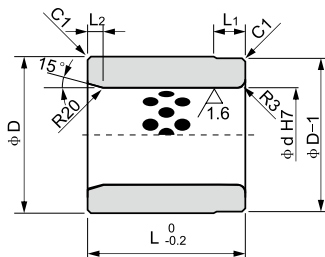

JPBF	FC250 # + Graphite
	铸铁 + 石墨
JPBW	600 # + Graphite
	高力黄铜 + 石墨

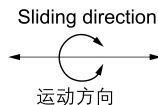

单位unit:mm

型号规格 Standard No.	d	d	H7	D	公差 Tolerance	L	L ₁	L ₂
JPBW JPBF	25	25	+0.021	40	± 0.008	40	10	5
	30	30	0	50		50		
	35	35	+0.025	60	± 0.0095	55	15	
	40	40		60		10		
	50	50	0	70		75	15	10
	60	60	+0.030	80		90	20	
	80	80	0	100	± 0.011	120	25	
	100	100	+0.035	120		150	25	
120	120	0	140	± 0.0125	180	25		

自润滑和免维护滑动轴承

JGBZ 自润滑板 JGBZ Oilless Wear Plate



Material	600 # + Graphite
材质	高力黄铜 + 石墨

W = 100, 120, 150

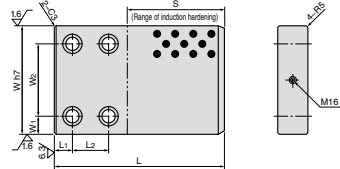

W = 50 and 70

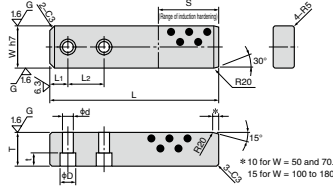

W = 180

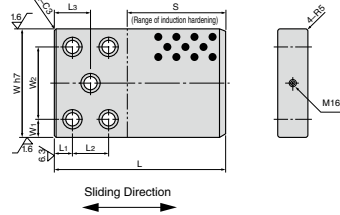

单位unit:mm

型号规格 Standard No.	W	L	W	h7	L ₁	L ₂	L ₃	W ₁	W ₂	D	d	t	e	s	T
JGBZ-50 × 160	50	160	50	0 -0.025	20	50									60
JGBZ-50 × 200		200				120									30
JGBZ-50 × 260		260				120									
JGBZ-70 × 230	70	230	70	0 -0.030	25	60			-	26	18	18	10		100
JGBZ-70 × 260		260				160									35
JGBZ-70 × 300		300				160									
JGBZ-70 × 350		350				150									
JGBZ-100 × 230		230				100									100
JGBZ-100 × 280	280	160													
JGBZ-100 × 330	330	160													
JGBZ-100 × 390	390	200	45												
JGBZ-120 × 230	230	120	120				60								
JGBZ-120 × 280	280					160									
JGBZ-120 × 330	330					160									
JGBZ-120 × 390	390					200									
JGBZ-150 × 280	280					150	150								
JGBZ-150 × 330	330	190	50												
JGBZ-150 × 390	390	190													
JGBZ-150 × 430	430	190													
JGBZ-180 × 280	280	180	180	0 -0.040	30			60		30					
JGBZ-180 × 330	330					190									
JGBZ-180 × 390	390					190									
JGBZ-180 × 430	430					190									
JGBZ-180 × 480	480					200	55								
JGBZ-180 × 550	550					250									

JOPF, JOPS, JOPW 自润滑板
JOPF, JOPS, JOPW Oilless Wear Plate

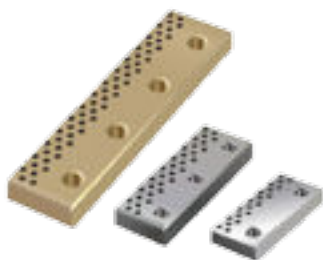

JOPF	FC250 # + Graphite 铸铁 + 石墨
JOPW	600 # + Graphite 高力黄铜 + 石墨
JOPS	S45C + Graphite 碳钢 + 石墨, HRC≥40

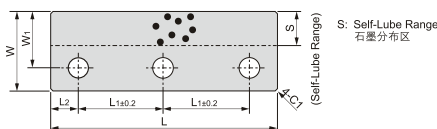
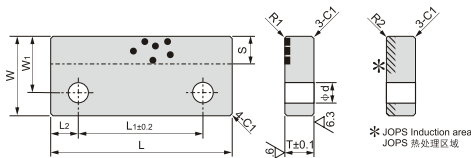

Sliding directions
运动方向

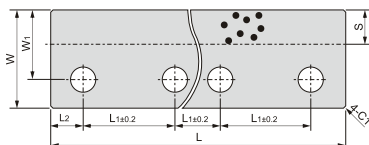
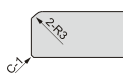

单位unit:mm

型号规格 Standard No.	W	L	T	W ₁	L ₁	L ₂	d	s	螺栓孔数量 Bolt Hole Q'ty
JOPF-55 × 180	55	180		37.5	120	30	24		2
JOPF-70 × 160	70	160	25	50	110	25	25	18	
JOPF-70 × 200	70	200		50	75	25	25	30	3
JOPF-70 × 240	70	240		50	90	30	30	30	
JOPF-85 × 200	85	200		60	75	25	25		4
JOPF-85 × 240	85	240		60	90	30	30		
JOPF-85 × 300	85	300		60	80	30	30		4
JOPF-85 × 350	85	350		60	90	40	40	22	
JOPF-100 × 200	100	200	28	70	75	25	25	30	3
JOPF-100 × 240	100	240		70	90	30	30		
JOPF-100 × 300	100	300		70	80	30	30		4
JOPF-100 × 350	100	350		70	90	40	40		
JOPF-70 × 160	70	160		50	110	25	25	18	2
JOPF-70 × 200	70	200	25	50	75	25	25	18	3
JOPF-70 × 240	70	240		50	90	30	30	30	
JOPW-70 × 160	70	160		50	110	25	25	18	2
JOPW-70 × 200	70	200	25	50	75	25	25	18	
JOPW-70 × 240	70	240		50	90	30	30	30	3
JOPW-70 × 300	70	300		50	80	30	30	30	
JOPW-85 × 200	85	200		60	75	25	25		4
JOPW-85 × 240	85	240		60	90	30	30		
JOPW-85 × 300	85	300	28	60	80	30	30	22	3
JOPW-85 × 350	85	350		60	90	40	40	22	

型号规格 Standard No.	W	L	T	W ₁	L ₁	L ₂	d	s	螺栓孔数量 Bolt Hole Q'ty
JOPS-85 × 200	85	200		60	75	25	25		3
JOPS-85 × 240	85	240		60	90	30	30		
JOPS-85 × 300	85	300		60	80	30	30		4
JOPS-85 × 350	85	350		60	90	40	40	22	
JOPS-100 × 200	100	200		70	75	25	25	30	3
JOPS-100 × 240	100	240		70	90	30	30		
JOPS-100 × 300	100	300		70	80	30	30		4
JOPS-100 × 350	100	350		70	90	40	40		
JOPW-70 × 160	70	160		50	110	25	25	18	2
JOPW-70 × 200	70	200	25	50	75	25	25	18	3
JOPW-70 × 240	70	240		50	90	30	30	30	
JOPW-70 × 300	70	300		50	80	30	30	30	4
JOPW-70 × 350	70	350		50	90	40	40	30	

自润滑和免维护滑动轴承

JCSDP 自润滑板 JCSDP Oilless Wear Plate

Material	600 # + Graphite
材质	高力黄铜 + 石墨

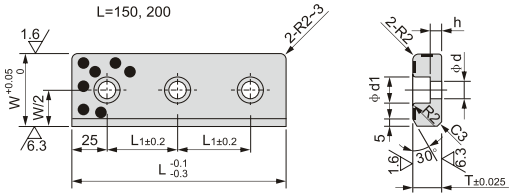

Sliding directions
运动方向

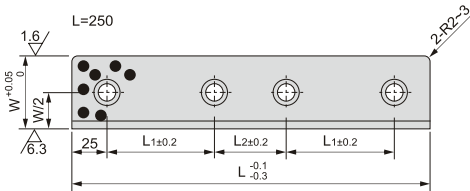

单位unit:mm

型号规格 Standard No.	W	L	T	L ₁	L ₂	d	d ₁	h
JCSDP 50 × 150 × 20	50	150	20	50	-	11	17.5	8
JCSDP 50 × 200 × 20		200		75	50			
JCSDP 50 × 250 × 20		250		75	50			
JCSDP 50 × 150 × 35		150	35	50	-	13	20	20
JCSDP 50 × 200 × 35		200		75	50			
JCSDP 50 × 250 × 35		250		75	50			
JCSDP 50 × 150 × 20	75	150	20	50	-	11	17.5	8
JCSDP 50 × 200 × 20		200		75	50			
JCSDP 50 × 250 × 20		250		75	50			
JCSDP 50 × 150 × 35		150	35	50	-	13	20	20
JCSDP 50 × 200 × 35		200		75	50			
JCSDP 50 × 250 × 35		250		75	50			

JCBS,JCBSP 凸轮底部导板
 JCBS,JCBSP Oilless Cam Btroke Guide Plate

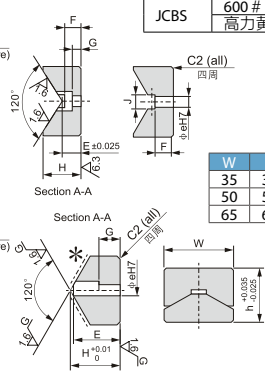
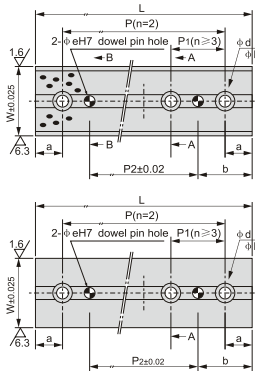

JCBSP	S45C+Graphite 钢基+石墨 HRC≥55
JCBS	600# + Graphite 高力黄铜+石墨

W	h	d	D
35	35	9	14
50	50	11	17.5
65	65	11	17.5

* Induction area
 热处理区域

单位unit:mm

型号规格 Standard No.	W	L	H	a	b	P	P1	螺栓数量 No. of Bolt Holes	e	P2	E	G	J
JCBS-75 × 35	35	75	24	15	30	45	-	2	8	15	15	4	11
JCBS-100 × 35		100		20	40	60				20			
JCBS-125 × 35		125		20	40	85				45			
JCBS-150 × 35		150		20	40	110				70			
JCBS-75 × 50	50	75	31	15	30	45	-	2	10	15	15	8	13
JCBS-100 × 50		100		20	40	60				20			
JCBS-125 × 50		125		25	50	75				25			
JCBS-150 × 50		150		25	50	100				50			
JCBS-100 × 65	65	100	35	20	40	60	50	3	10	20	18	-	-
JCBS-150 × 65		150		25	50	-				50			
JCBS-200 × 65		200		25	50	-				100			
JCBS-250 × 65		250		25	50	-				150			
JCBS-300 × 65		300		25	50	-		6		200			

型号规格 Standard No.	W	L	H	a	b	P	P1	螺栓数量 No. of Bolt Holes	e	P2	E	G
JCBSP-75 × 35	35	75	20	15	30	45	-	2	8	15	17	4
JCBSP-100 × 35		100		20	40	60				20		
JCBSP-125 × 35		125		20	40	85				45		
JCBSP-150 × 35		150		20	40	110				70		
JCBSP-75 × 50	50	75	32	15	30	45	-	2	10	15	29	10
JCBSP-100 × 50		100		20	40	60				20		
JCBSP-125 × 50		125		25	50	75				25		
JCBSP-150 × 50		150		25	50	100				50		
JCBSP-100 × 65	65	100	47	20	40	60	50	3	10	20	44	20
JCBSP-150 × 65		150		25	50	-				50		
JCBSP-200 × 65		200		25	50	-				100		
JCBSP-250 × 65		250		25	50	-				150		
JCBSP-300 × 65		300		25	50	-		6		200		

JSPW, JSPS 凸轮行程滑板 JSPW, JSPS Cam Stroke Plate



JSPS	S45C+Graphite 钢基 + 石墨 HRC≥55
JSPW	600 # + Graphite 高力黄铜 + 石墨

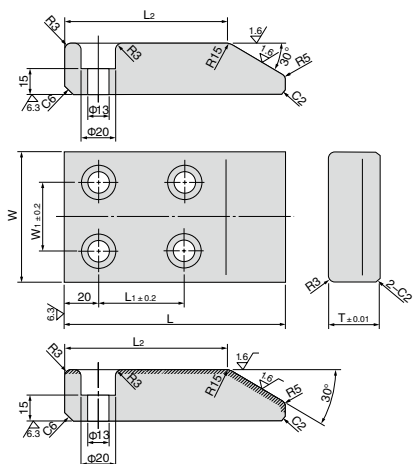
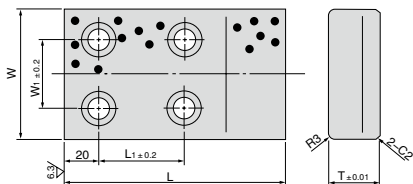

单位unit:mm

型号规格 Standard No.	W	L	T	W ₁	L ₁	L ₂
JSPW/JSPS-75 × 130	75	130	30	40	50	95
JSPW/JSPS-75 × 150		150	45		45	90
JSPW/JSPS-100 × 130		130	30		50	95
JSPW/JSPS-100 × 150	100	150	45	60	45	90
JSPW/JSPS-100 × 170		170	60		45	90
JSPW/JSPS-100 × 200		200	60		75	120
JSPW/JSPS-125 × 130	125	130	30	85	50	95
JSPW/JSPS-125 × 150		150	45		45	90
JSPW/JSPS-125 × 170		170	60		45	90
JSPW/JSPS-125 × 200		200	60		75	120
JSPW/JSPS-150 × 130	150	130	30	110	50	95
JSPW/JSPS-150 × 150		150	45		45	90
JSPW/JSPS-150 × 170		170	60		45	90
JSPW/JSPS-150 × 200		200	60		75	120

JSPQ,JSPQS 凸轮行程滑板
JSPQ,JSPQS Cam Stroke Plate

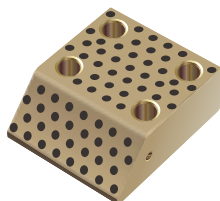

JSPQS	S45C + Graphite 铜基 + 石墨HRC≥55
JSPQ	650 # + Graphite 高力黄铜 + 石墨

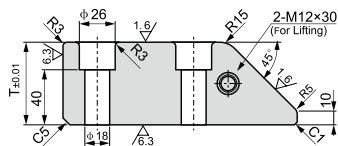
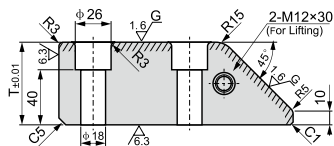
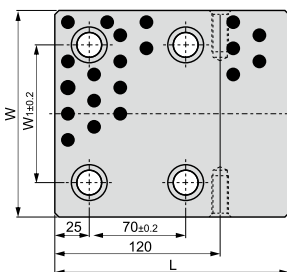
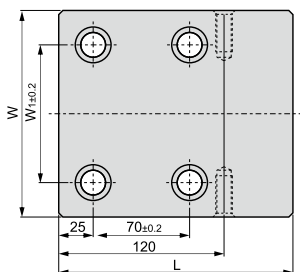

Sliding directions
运动方向

单位unit:mm

型号规格 Standard No.	W	L	T	W ₁
JSPQ/JSPQS-150 × 170	150	170	60	100
JSPQ/JSPQS-150 × 200	150	200	90	100
JSPQ/JSPQS-200 × 170	200	170	60	140
JSPQ/JSPQS-200 × 200	200	200	90	140

自润滑和免维护滑动轴承

JPWS,JPSS 凸轮行程滑板 JPWS,JPSS Cam Stroke Plate

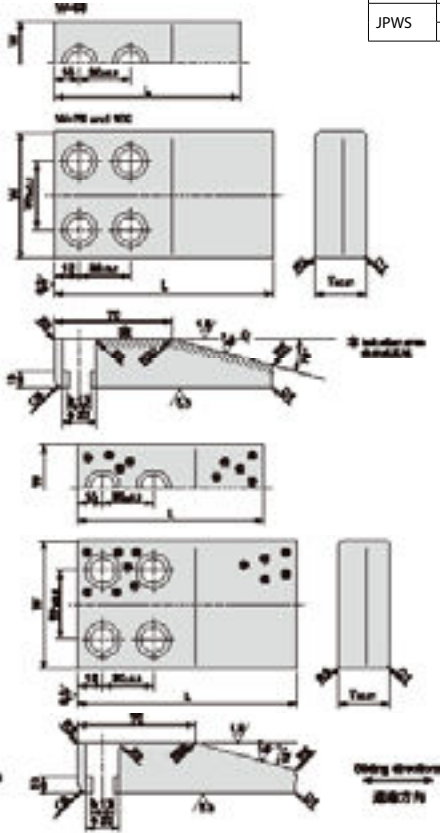

JPSS	S45C + Graphite 铜基 + 石墨HRC≥55
JPWS	650 # + Graphite 高力黄铜 + 石墨

单位unit:mm

型号规格 Standard No.	W	L	T	W ₁
JPWS/JPSS-50 × 110	50	110	25	—
JPWS/JPSS-50 × 130	50	130	30	—
JPWS/JPSS-75 × 110	75	110	25	40
JPWS/JPSS-75 × 130	75	130	30	40
JPWS/JPSS-100 × 110	100	110	25	60
JPWS/JPSS-100 × 130	100	130	30	60

JPGPB 自润滑板
JPGPB Oilless Wear Plate

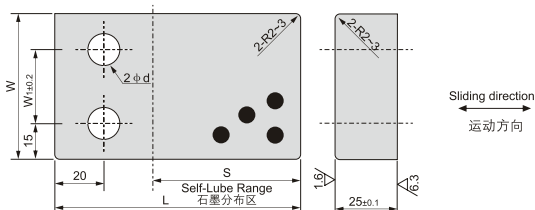

Material	600 # + Graphite
材质	高力黄铜 + 石墨

单位unit:mm

型号规格 Standard No.	W	L	S	W ₁	d
JPGPB-60 × 80	60	80	40	30	13
JPGPB-60 × 100	60	100	60	30	13
JPGPB-60 × 120	60	120	80	30	13
JPGPB-100 × 80	100	80	40	70	18
JPGPB-100 × 100	100	100	60	70	18
JPGPB-100 × 120	100	120	80	70	18
JPGPB-150 × 80	150	80	40	120	18
JPGPB-150 × 100	150	100	60	120	18
JPGPB-150 × 120	150	120	80	120	18

JPGPC 自润滑板
JPGPC Oilless Wear Plate

Material	600 # + Graphite
材质	高力黄铜 + 石墨

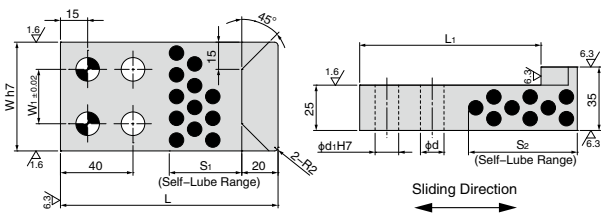

单位unit:mm

型号规格 Standard No.	W	h7	L ₁	L ₂	S ₁	S ₂	W ₁	d	d ₁
JPGPC-60 × 120	60		120	100	40	60	30	13	13
JPGPC-60 × 140	60	0 -0.030	140	120	60	80	30	13	13
JPGPC-60 × 160	60		160	140	80	100	30	13	13
JPGPC-100 × 120	100		120	100	40	60	70	18	16
JPGPC-100 × 140	100	0 -0.035	140	120	60	80	70	18	16
JPGPC-100 × 160	100		160	140	80	100	70	18	16
JPGPC-150 × 120	150		120	100	40	60	120	18	16
JPGPC-150 × 140	150	0 -0.040	140	120	60	80	120	18	16
JPGPC-150 × 160	150		160	140	80	100	120	18	16

JPRP 凸轮退回滑板 JPRP Oilless Cam Positive Return Plate

Material	600 # + Graphite
材质	高力黄铜 + 石墨

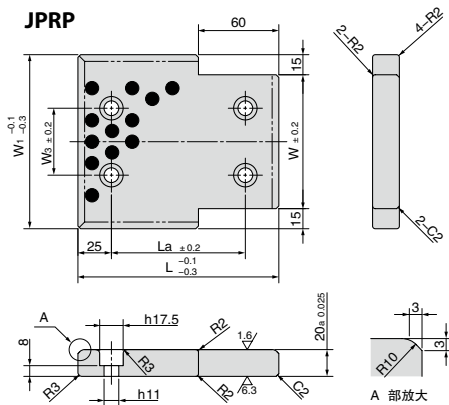
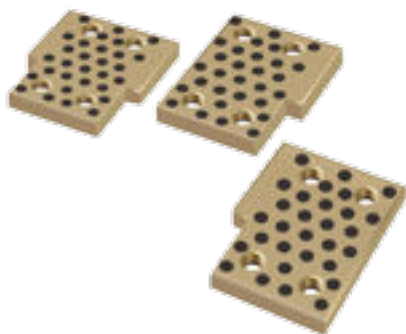

JPRPL

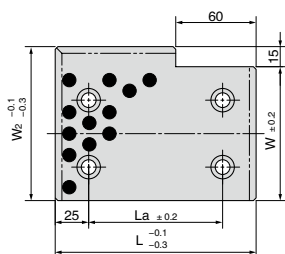

JPRPR

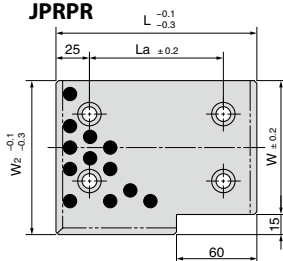

单位:unit:mm

材料 Material	型号规格 Standard No.	W	L	W1	W2	W3	La
JPRP JPRPL JPRPR	75 × 100	75	100	105	90	40	50
	75 × 125	75	125	105	90	40	75
	75 × 150	75	150	105	90	40	100
	100 × 125	100	125	130	115	50	75
	100 × 150	100	150	130	115	50	100
	125 × 150	125	150	155	140	75	100
	125 × 200	125	200	155	140	75	150
	125 × 250	125	250	155	140	75	200
	150 × 200	150	200	180	165	100	150
150 × 250	150	250	180	165	100	200	

JOCU 自润滑倾斜顶出件
JOCU Oilless Inclined Bolt Guide

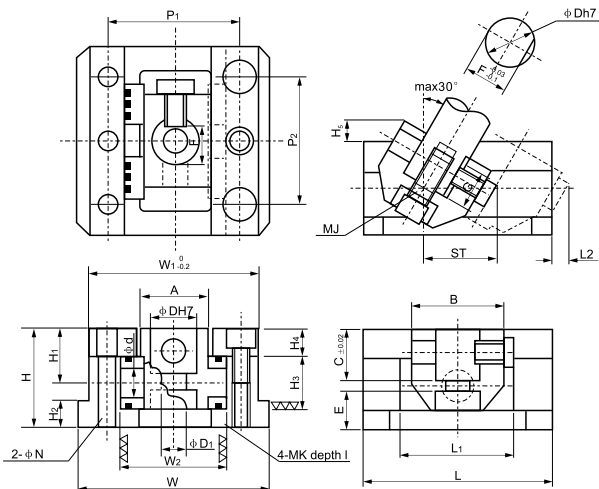

单位unit:mm

产品代号 Standard No.	ΦD	Φd	ΦD ₁	A	B	C	E	F	G	MJ	H	H ₁	H ₂	H ₃	H ₄
JOCU-8	8	7	4.5	11	20	8	10	7	8	M4	22	12.5	5	11	7
JOCU-10	10	7	4.5	15	25	10	12.5	9	9	M5	27	15.5	5	15	8
JOCU-12	12	10	7	17	25	12	15	11	10	M6	32	18	7	16	10
JOCU-16	16	12	9	22	30	16	15	14.5	12	M8	36	20	8	20	10
JOCU-20	20	14	11	26	40	20	16	18	16	M10	42	23	11	22	12
JOCU-25	25	16	14	32	45	25	17	22.5	20	M12	50	28	15	26	15
JOCU-30	30	18	14	38	50	30	17	27	25	M12	55	30	15	30	15
JOCU-35	35	20	14	45	60	35	18	32	30	M12	62	35	15	34	18
JOCU-40	40	25	18	55	70	40	19	36	35	M16	70	40	15	44	18
JOCU-45	45	30	18	60	80	45	24	40	40	M16	80	45	15	50	20

产品代号 Standard No.	H ₅	L	L ₁	L ₂	W	W ₁	W ₂	P ₁	P ₂	MK	l	ΦN	ST
JOCU-8	10.5	32	20	3.6	33	30	19	24	20	M3	9.5	3	10
JOCU-10	11.3	45	25	4.5	45	40	25	32	30	M4	14	4	18
JOCU-12	4	50	30	8	57	51	31	39	35	M6	14	6	20
JOCU-16	5	65	40	8	65	58	38	46	40	M6	16	6	25
JOCU-20	8	80	50	8	80	72	44	56	55	M8	19	8	30
JOCU-25	8	90	55	12	93	85	52	66	65	M10	22	10	35
JOCU-30	9	100	60	12	101	93	60	74	70	M10	25	10	40
JOCU-35	10	120	75	8	120	110	70	85	80	M12	27	10	45
JOCU-40	12	135	85	8	130	120	80	95	90	M12	30	10	50
JOCU-45	14	150	95	10	140	130	90	105	110	M12	35	10	55